



品质依生 品致未来
Quality create future



浙江镇田机械有限公司
ZHEJIANG JHENTEN MACHINERY CO., LTD

地址: 温州市经济技术开发区滨海园区海桐路808号
Add: No.808 Haitong Road, Binhai Development Zone, Wenzhou Economic and Technological Development Zone, Zhejiang, China
Postcode: 325025
Tel: +86-577-86867777
Service: +86-577-86825195
Fax: +86-577-86810195
E-mail: jhenten@jhenten.com
Website: www.jhenten.com

声明:
本资料所有产品外观图片、颜色、参数仅供参考, 浙江镇田机械有限公司保留随时修改并不预先告知的权利。

Statement:
All products appearance picture, color, parameters in the data for reference only. Zhejiang Jhenten Machinery Co., Ltd. reserves the right to change at any time without advance inform

过滤器目录

浙江镇田机械有限公司

Filtration Catalog 2023
Zhejiang Jhenten Machinery Co., Ltd.



关于镇田 About Jhenten

浙江镇田机械有限公司成立于1986年，拥有超过30年的设计、制造和服务特殊不锈钢罐和容器的经验。在镇田，我们的工程技术和专业知识始终专注于存储容器、工艺罐和定制不锈钢制造的创新和复杂的卫生级设计。我们的客户认识到镇田正在为所在行业中最具挑战性的存储、混合和处理应用程序获得最高价值的产品和技术提供解决方案。镇田机械背后的技术能力确保了高质量的产品在混合、搅拌、加工和储存的广泛应用。

- 制药工程
- 食品饮料
- 日化
- 精细化工
- 新能源

镇田设计产品采用优质的原材料和最先进的制造工艺，在广泛的不锈钢容器(包括搅拌容器、压力容器、水平和立式储罐)应用中实现客户对产品的期望。

镇田可以根据特定容器体积、设计和使用要求为客户提供合适的搅拌技术、传热解决方案和清洗方案。

- 我们为各类立式及卧式储罐制造独特的垂直和水平搅拌。
- 我们制造全系列搅拌器—推进式、涡轮式、桨叶式、锚框式、螺带式等—用于加工、混合和混合容器。
- 我们设计不同的传热表面形式，包括蜂窝板、盘管和半管夹套，用于几乎任何容器的加热和冷却。
- 我们选择各种清洁方式——CIP、喷淋球——有助各类容器的清洁，降低能耗，降低清洁周期的需水量。

镇田可以满足您所有特殊行业的应用，使用更高级的合金(如Hastalloy和钛等材料)定制不锈钢设备容器。如果压力容器需要美国机械工程师协会(ASME)认证，我们可以将其与其他规范一起提供，包括加拿大CRN和欧盟PED。

镇田机械制造的产品已经被认为是不锈钢制造行业的一个标杆，我们始终秉承传统的价值观，对工作不懈努力和对产品可靠性保证。我们的员工始终以质量为导向，并不断利用创新的设计和简化流程。这显示了镇田在与客户分享我们的工程技术、设计能力和制造经验方面的优势。



Zhejiang Jhenten Machinery found on 1986, have more than 30 years experience on designs, builds, and services exceptional stainless steel vessels. We focus our engineering skills and expertise on the innovative and sophisticated sanitary design of storage vessels, process tanks, and custom stainless steel fabrications. Our customers recognize that they are getting the highest value products and technology solutions for the most challenging storage, mixing and processing applications in their industries. The technology behind Jhenten Engineered Products ensures quality in a wide range of markets that mix, blend, process and store.

- Personal Care
- Food & Beverage
- Pharmaceuticals
- Fine Chemicals
- New energy

Jhenten Engineered Products uses leading edge materials and state of the art fabrication to deliver on our customers' expectations across a broad range of stainless steel tanks for storage, mixing and processing, including agitated vessels, pressure vessels, horizontals and vertical storage tanks.

The agitation technologies, heat transfer solutions and cleaning options Jhenten provides to customers are designed for the demands of specific vessel content, design and use.

- We manufacture unique vertical and horizontal agitation for different tanks.
- We fabricate a full line of agitators—Propeller, turbine, paddle, anchor, ribbon and more—for processing, mixing, and blending vessels.
- We engineer heat transfer surfaces including dimple, channel and half pipe for heating and cooling of virtually any vessel.
- Various cleaning options—CIP, spray ball—facilitate the cleanability of vessels, reduce energy consumption, and lower water demand in the cleaning cycle.

Jhenten can meet the specifications of all your specialized applications with custom stainless steel fabrication using higher alloys such as Hastalloy and Titanium and so on. And if a pressure vessel requires ASME certification, we can provide that along with other codes, including CRN and PED.

Jhenten Engineered Products is perceived as a quality organization in stainless steel manufacturing, held in high regard for its traditional values of hard work and reliability. Our employees are quality driven, always ready to take advantage of new ideas and streamline processes. And this shows in the pride they take in sharing our engineering know-how, design capabilities and fabrication experience with our customers.

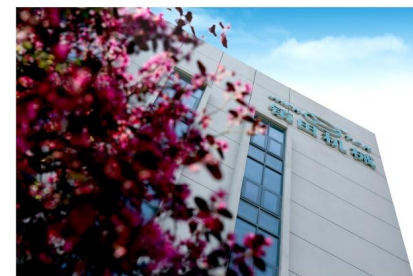

专业服务洁净工程
Professional Service For
Sanitary Project

设计研发 Design and R&D



镇田全面的创新技术，拥有国内领先的硬件、软件设施、专业的技术研发队伍，在项目开发阶段，项目小组承建工艺、工程设计，通过大量使用工业工程电脑辅助设计及工艺模拟系统，通过CAD电脑辅助设计，三维的模拟效果，镇田能够优化整个生产过程的效果，使客户对整个项目一目了然。

Jhenten has a comprehensive range of innovative technologies, with leading hardware, software facilities, and professional technical R&D teams. In the project development stage, the project team has built process and engineering designs. Through the use of industrial engineering computer-aided design and process simulation systems, CAD Computer-aided design, three-dimensional simulation results, Jhenten can optimize the effect of the entire production process, allowing customers to see the entire project at a glance.



生产车间 Production Workshop



科学技术是第一生产力，科学技术也是企业的核心竞争力。不断加强核心技术的研发和创新，不断追求卓越，精益求精，以先进的生产设备，严格的质量管理，精密的生产检测流程，保证每一款产品的优良性能。

生产工具是生产力发展水平的标志，先进的生产设备代表了先进的生产力。公司积极引进先进的技术和生产设备，使产品内在品质与外在个性化紧密结合，完全满足并引领工业现代化的需求。

Science and technology are the primary productive forces, and science and technology are also the core competitiveness of enterprises. Continuously strengthen the research and development of core technologies, innovate continuously, strive for excellence, keep improving, use advanced production equipment, strict quality control, and precise production testing procedures to ensure the excellent performance of each product.

Production tools are a sign of the level of productivity development. Advanced production equipment represents advanced productivity. The company actively introduces advanced technology and production equipment to closely integrate the intrinsic quality of the product with the external personalization, fully satisfying and leading the needs of industrial modernization.

高品质产品要求 精心设计、精心制造、精益求精

High quality products require elaborate design, well-crafted manufacturing and continuous improvement.

资质证书 Qualification Certificate



合作伙伴 Cooperative Partner



以下商标与注册商标属于各自所有，排列不分先后
The above trademarks and registered trademarks
belong to their respective ownership, the arrangement is not
divided successively.



产品目录

Product Catalog



1 袋式过滤器

Bag Filter

JTGCD 侧入式袋式过滤器	10
JTGCD Side Entry Bag Filter	
JTGDD 顶入式袋式过滤器	12
JTGDD Top Entry Bag Filter	
JTGDS 多袋式过滤器	14
JTGDS Multi Bags Filter	

3 工业级芯式过滤器

Industrial Cartridge Filter

JTGDD 单芯工业级液体过滤器	24
JTGDD Casting Single Cartridge Filter	
JTGSF 工业级精密过滤器	26
JTGSF Industrial Grade Precision Liquid Filter	
JTGHF 大流量液体过滤器(大胖过滤器)	30
JTGHF Large Flow Liquid Filter	
JTGRP 保安过滤器	32
JTGRP Security Filter	
JTGYB 翻转钛棒过滤器	34
JTGYB Swing Titanium Rod Fluid Filter	
JGTGB 金属精密过滤器	36
JGTGB Metal Precision Cartridge Filter	

2 卫生级芯式过滤器

Sanitary Cartridge Filter

JTGDX 单芯卫生级液体过滤器	16
JTGDX Single Cartridge Sanitary Filter	
JTGDL 多芯液体过滤器	18
JTGDL Multi Cartridge Sanitary Filter	
JTGJM 精密液体过滤器	20
JTGJM Precision Liquid Filter	

4 工业管道过滤器

Industrial Pipe Filter

JTGLL 篮式过滤器	38
JTGLL Basket Strainer	
JTGLF 直立式过滤桶	40
JTGLF Basket Type Filter	
JGTGF 管式过滤器	42
JGTGF Tube Filter	
JTGYG Y型过滤器	44
JTGYG Y-Type Filter	
JTGXX 磁棒过滤器	46
JTGXX Magnetic Fluid Filter	
JTGMF 机械过滤器	48
JTGMF Mechanical Filter	
JTHXQ 呼吸器	50
JTHXQ Vent housing	

5 层叠过滤器

Cascade Filter

JTGDB 大饼式过滤器	52
JTGDB Lenticular Filter	
JTGYP 圆盘式硅藻土过滤器	54
JTGYP Disc-type Diatomite Filter	

7 典型过滤系统

Typical Filtration System

双联(多联)过滤器	58
Duplex (Multi) Strainer	
反渗透系统	59
Reverse Osmosis System	
葡萄酒过滤系统	60
Wine Filtration System	
气体除菌过滤系统	61
Gas Sterilization Filtration System	
无菌水设备过滤系统	62
Sterile Water Equipment Filtration Systems	

6 空气过滤器

Gas Filter

JTGKQ 空气(蒸汽)过滤器	56
JTGKQ Gas(Steam) Filter	

8 过滤器参数表

Filter Housing Parameters

过滤器参数表	63
Filter Housing Parameters	
PP/PE/NMO液体滤袋	66
Liquid Filter Bag	
聚丙烯(PP)微孔膜折叠滤芯	68
PP Microporous Membrane Folding Filter Cartridge	
聚醚砜(PES)微孔膜折叠滤芯	70
PES Microporous Membrane Folding Filter Cartridge	
不锈钢烧结/折叠滤芯(熔体滤芯)	72
Stainless Steel Sintered / Folding Filter Cartridge (Melt Filter Cartridge)	
钛棒滤芯	73
Titanium Filter Cartridge	
大流量滤芯(大胖滤芯)	74
Large Flow Filter Cartridge	
深层膜堆滤芯(大饼滤芯)	75
Depth-Stack Filter Cartridge (Filter Cake)	



JTGCD
侧入式袋式过滤器
Side Entry Bag Filter经济型单袋式过滤器
Single bag filter

- JTGCD侧入式袋式过滤器，一款配合滤袋使用的袋式过滤器，用于一些粗过滤及预过滤环节。
- 侧进下出或侧进侧出的结构，有效地节省了过滤器的空间，整个结构经济合理。
- 用压环、弹簧压紧滤袋环口，保证了过滤器与滤袋之间良好的密封。
- 可调支脚，安装尺寸可根据现场要求快速调整。
- JTGCD Side-entry bag filter with single filter bag is for some coarse filtration and pre-filtration process.
- Side entry structure is a economical and reasonable design which can effectively save space of the filter.
- Pressure ring and the spring ensure good seal between the filter and the filter bag.
- With adjustable legs, the installation size can be adjusted according to the requirements of the particular spot.



连接 Connection

壳体连接 Connection of shell	法兰 Flange
进出口N1、N2 In-outlet	法兰、快装、螺纹 Flange, Tri-clamp, Thread
压力表N3(选配) N3 Pressure gauge (option)	1.5"快装Tri-clamp (1号袋#Bag/2号袋#Bag) M14×1.5内螺纹Female thread (3号袋#Bag/4号袋#Bag)
排气阀N4(选配) N4Vent valve (option)	1/4"外螺纹 Male thread

表面处理 Surface Finish

处理类型Finish type	机械抛光、电解抛光、喷砂 Mechanical / Electrolytical polishing Sand blasting
抛光精度 Polishing precision	内壁 0.6 μm Inner surface Ra≤0.6 μm 外壁 0.8 μm Outside surface Ra≤0.8 μm 支撑罐盖 0.6 μm Basket 0.6 μm

尺寸参数表 Dimension Parameters

	模压盖/平盖		平盖Cover	
	1号袋	2号袋	3号袋	4号袋
A: 总高(不含压力表) Total height	990	1365	525	635
B: 进口中心距 The distance from inlet to center	147		92	
C: 直径 Shell diameter	Φ204	Φ204	Φ114	Φ114
D1: 进口离地高度 The height from inlet to ground	835	1205	445	555
D2: 出口离地高度 The height from outlet to ground	250		300	
进出口 In-outlet N1、N2尺寸 Size	1.5"或2"		1"或1.5"	
E: 可调支脚高度 Stabilizer blade	500	800	300	400
最大流量 Max flow m ³ /h	20	40	6	12

上表数据为标准型，仅供参考，可根据客户要求定制；未注长度单位为mm。
The above-mentioned data is the standard, it can customize according to customer's requirements.

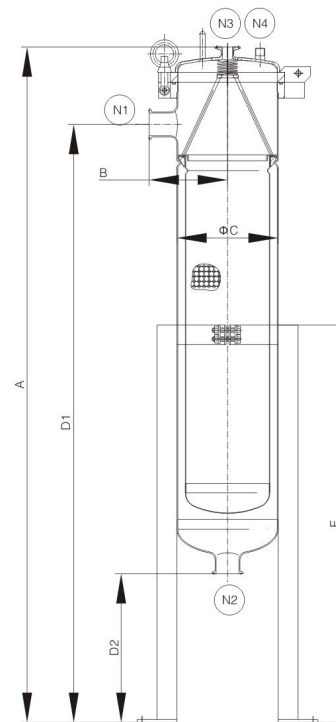

侧入式袋式过滤器 Side entry bag filter

操作条件 Operating Conditions

最大操作压力 Max operating pressure	0.6MPa、1.0MPa
最大操作温度 Max operating temperature	150℃

材料 Material

过滤器壳体 Shell	304、316L、双相钢、钛材、哈氏合金 304, 316L, Duplex SS, Titanium, Hastelloy
吊环螺栓 Eyebolt	304
可调支脚 Stabilizer blade	304
密封圈、垫片 O-ring	三元乙丙橡胶、聚四氟乙烯、 氟橡胶、硅橡胶 EPDM, PTFE, Viton, Silicone

JTGCD 选型表 Selection Table

〔 滤袋数量 Qty. of Bag Filter 〕	〔 滤袋型号 Model of Bag Filter 〕	〔 壳体材料 Shell Material 〕	〔 进出口连接 In-outlet connection 〕	〔 密封圈O-ring 〕
1P	2S	4	F	E
1P=1袋 Pc	1S=1号袋1#Bag; Φ180 x 430 2S=2号袋1#Bag; Φ180x 810 3S=3号袋1#Bag; Φ105 x 230 4S=4号袋1#Bag; Φ105x 380	4= 304 6= 316L D=双相钢Duplex SS T=钛材Titanium H=哈氏合金Hastelloy	F=法兰 Flange K=快装 Tri-clamp L=螺纹 Thread	E=三元乙丙橡胶 EPDM P=聚四氟乙烯 PTFE V=氟橡胶 Viton S=硅橡胶 Silicone

JTGDD 顶入式袋式过滤器 Top Entry Bag Filter

结构最合理的单袋式过滤器
Single bag filter with the most
reasonable structure

- JTGDD顶入式袋式过滤器，一款配合滤袋使用的袋式过滤器，用于一些粗过滤及预过滤环节。
- 侧面入口进入，再从顶部进入滤袋内的设计，能自动分压，不会产生紊流，减少压力损失，有效保护滤袋。
- 顶盖全面压紧密封，密封效果更好，杜绝侧漏。
- 可调支脚，安装尺寸可根据现场要求快速调整。

- JTGDD Top Entry Bag Filter Housing for some coarse filtration and pre-filtration process.
- The design of side entry first and then top entry into the filter bag does not cause turbulence and not reduce pressure because of the stabled pressure. Also this structure effectively protects the filter bag.
- The top cover is fully pressed and sealed, and the sealing effect is better.
- With adjustable legs, the installation size can be adjusted according to the requirements of the particular spot.



操作条件 Operating Conditions

最大操作压力 Max operating pressure	0.6MPa、1.0MPa
最大操作温度 Max operating temperature	150℃

材料 Material

过滤器壳体 Shell	304、316L、双相钢、钛材、哈氏合金 304, 316L, Duplex SS, Titanium, Hastelloy
吊环螺栓 Eyebolt	304
可调支脚 Stabilizer blade	304
密封圈、垫片 O-ring	三元乙丙橡胶、聚四氟乙烯、 氟橡胶、硅橡胶 EPDM, PTFE, Viton, Silicone

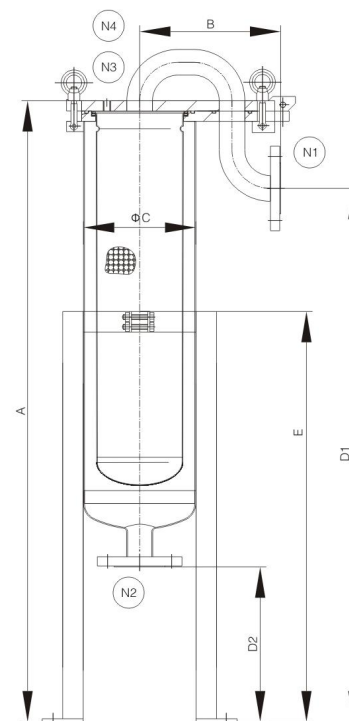

顶入式袋式过滤器 Top entry bag filter

Connection

壳体连接 Connection of shell	法兰 Flange
进出口N1、N2 In-outlet	法兰、快装、螺纹 Flange, Tri-clamp, Thread
压力表N3(选配) N3 Pressure gauge (option)	M14 × 1.5内螺纹 M14 × 1.5 Female thread (3#Bag /4#Bag)
排气阀N4(选配) N4Vent valve (option)	1/4"外螺纹 Male thread

表面处理 Surface Finish

处理类型 Finish type	机械抛光、电解抛光、喷砂 Mechanical / Electrolytical polishing Sand blasting
抛光精度 Polishing precision	内壁 0.6 μm Inner surface Ra≤0.6 μm 外壁 0.8 μm Outside surface Ra≤0.8 μm 支撑滤篮 0.6 μm Basket 0.6 μm

尺寸参数表 Dimension Parameters

	平盖 Cover	
	1号袋	2号袋
A: 总高(不含压力表) Total height The distance from inlet to center	790	1110
B: 进口中心距 The distance from inlet to center	275	
C: 直径 Shell diameter	Φ 204	Φ 204
D1: 进口离地高度 The height from inlet to ground	620	940
D2: 出口离地高度 The height from outlet to ground	200	
进出口 In-outlet N1、N2尺寸 Size	1.5 或 2"	
E: 可调支脚高度 Stabilizer blade	550	700
最大流量 Max flow m³/h	20	40

上表数据为标准型，仅供参考，可根据客户要求定制；未注长度单位为mm。
The above-mentioned data is the standard, it can customize according to customer's requirements.

JTGDD 选型表 Selection Table

〔 滤袋数量 Qty. of Bag Filter 〕	〔 滤袋型号 Model of Bag Filter 〕	〔 壳体材料 Shell Material 〕	〔 进出口连接 In-outlet connection 〕	〔 密封圈 O-ring 〕
1P	2S	4	F	E
1P=1袋 Pc	1S=1号袋 1#Bag; Φ 180 x 430 2S=2号袋 1#Bag; Φ 180x 810 3S=3号袋 1#Bag; Φ 105 x 230 4S=4号袋 1#Bag; Φ 105x 380	4= 304 6= 316L D=双相钢 Duplex SS T=钛材 Titanium H=哈氏合金 Hastelloy	F=法兰 Flange K=快装 Tri-clamp L=螺纹 Thread	E=三元乙丙橡胶 EPDM P=聚四氟乙烯 PTFE V=氟橡胶 Viton S=硅橡胶 Silicone

JTGDS 多袋式过滤器 Multi Bags Filter

大流量袋式过滤器 High flow bag filter

典型的应用

食品及饮料；生物工程及医药；石化及化工；汽车制造；石油及天然气；电子及电镀；涂料、油漆、油墨；核电与火电及废液过滤；摄影胶片生产工艺液体过滤；日用化工的液体和气体净化；机械加工及制冷行业各种冷却液过滤；纺织、印染、造纸行业的各种液体净化。

Application

Food and beverage; bio engineering and pharmaceutical; petrochemical and chemical; automobile manufacturing; petroleum and natural gas; electronic and natural gas; coating, paint, printing ink; nuclear power and thermal power and waste water filtration; liquid and gas purification of liquid and gas.



产品特点

- 处理流量大,使用寿命长。
- 滤器设计紧凑,减少占地空间,同时减少液体的损失。
- 侧进底出的设计确保液体介质可被完全排放,同时采用了正切出口供选择,使得排污彻底,工人操作方便。
- 内部独特的三点压紧装置确保良好的滤袋密封性,避免液体旁漏。
- 多袋过滤器壳体可采用转臂+吊环螺栓设计或快开设计,操作方便,经济实用。

- JTGDS多袋式过滤器,一款配合滤袋使用的袋式过滤器,用于粗过滤及预过滤环节。
- JTGDS多袋式过滤器标配01号滤袋或02号滤袋,标准模式为2袋~12袋,定制最大生产到24袋,基本能满足各类流量的要求。
- JTGDS Multi bags filter, for some coarse filtration and pre-filtration process.
- JTGDS Standard No. 01 bag or 02 bag, the standard model for 2 ~ 12 bags, and the maximum production customized to 24 bags can basically meet the requirements of various types of flow.

Feature

- Large flow, Long service life.
- Compact design can reduce occupied space and the loss of liquid.
- Side entry and bottom out ensure that liquid medium can be completely discharged, the tangential position outlet, discharging pollution thoroughly, is convenient to be operating.
- The unique three-point clamp device ensures good sealing and avoid liquid side leakage.
- The filter housing can add swing arm and the eyebolt or quick-open design, operating conveniently and economically.



摇臂式 Swing-arm Type

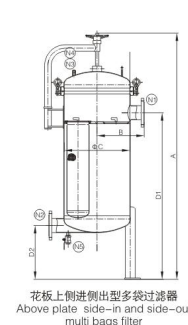

花板上侧进侧出型多袋式过滤器
Above plate side-in and side-out multi bags filter

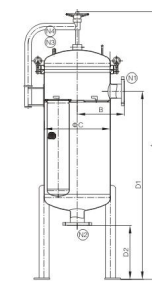

花板上侧进底出型多袋式过滤器
Side-in and bottom-out multi bags filter

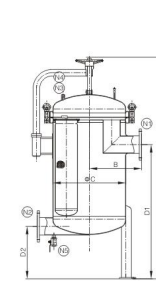

花板下侧进侧出型多袋式过滤器
Above plate side-in and side-out multi bags filter

快开式 Quick-open Type

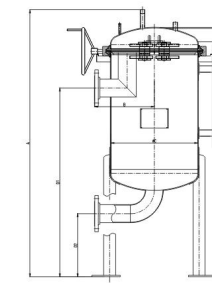

花板下侧进侧出型多袋式过滤器
Above plate side-in and side-out multi bags filter

操作条件 Operating Conditions

最大操作压力 Max operating pressure	1.0MPa
最大操作温度 Max operating temperature	150°C

表面处理 Surface Finish

处理类型 Finish type	机械抛光、电解抛光、喷砂 Mechanical / Electrolytical polishing Sand blasting
抛光精度 Polishing precision	内圆 0.6 μm Inner surface Ra≤0.6 μm 外圆 0.6 μm Outside surface Ra≤0.6 μm 支撑筋 0.6 μm Basket 0.6 μm

材料 Material

过滤器壳体 Shell	304、316L、双相钢、钛材、哈氏合金 304, 316L, Duplex SS, Titanium, Hastelloy
吊环螺栓 Eyebolt	304
可调支脚 Stabilizer blade	304
密封圈、垫片 O-ring	三元乙丙橡胶、聚四氟乙烯、 氟橡胶、硅橡胶 EPDM, PTFE, Viton, Silicone

连接 Connection

壳体连接 Connection of shell	法兰 Flange
进出口 N1、N2 In-outlet	法兰、快装、螺栓 Flange, Tri-clamp, Thread
压力表N3(选配) N3 Pressure gauge (option)	1/2"内螺纹 Female thread
排气阀N4(选配) N4 Vent valve (option)	1/2"外螺纹 Male thread
排液阀N5(选配) N5 Drain valve (option)	1/2"外螺纹 Male thread

尺寸参数表 Dimension Parameters

	2袋2号袋 2P2S		4袋2号袋 4P4S		6袋2号袋 6P2S		8袋2号袋 8P2S	
	花板上侧进底出	花板下侧进侧出	花板上侧进底出	花板下侧进侧出	花板上侧进底出	花板下侧进侧出	花板上侧进底出	花板下侧进侧出
A ₂ : 总高(不含压力表) Total height	1880	1530	2030	1600	2130	1700	2520	2060
B: 进口中心距 The distance from inlet to center	300		360	400	440	450	500	500
C: 直径 Shell diameter	Φ 400		Φ 500	Φ 550	Φ 650		Φ 750/800	
D1: 进口N1离地高度 The height from inlet to ground	1330	950	1425	975	1480	1000	1650	1150
D2: 出口N2离地高度 The height from outlet to ground	300		400	350	400		400	
N1、N2: 进出口尺寸 In-outlet N1、N2 size	4"		4"		5"		5"	

上表数据为标准型,仅供参考,可根据客户要求定制;未注长度单位为mm。
The above-mentioned data is the standard, it can customize according to customer's requirements.

JTGDS 选型表 Selection Table

[滤袋数量 Qty. of Bag Filter]	[滤袋型号 Model of Bag Filter]	[壳体材料 Shell Material]	[进出口连接 In-outlet connection]	[密封圈 O-ring]
3P	2S	4	F	E
2P=2袋 Pc	7P=7袋 Pc	1S=1号袋1#Bag; Φ 180 x 430	F=法兰 Flange	E=三元乙丙橡胶 EPDM
3P=3袋 Pc	9P=9袋 Pc	2S=2号袋1#Bag; Φ 180x 810	K=快装 Tri-clamp	P=聚四氟乙烯 PTFE
4P=4袋 Pc	12P=12袋 Pc		L=螺栓 Thread	V=氟橡胶 Viton
6P=6袋 Pc		T=钛材 Titanium		S=硅橡胶 Silicone
		H=哈氏合金Hastelloy		

JTGDX 单芯卫生级液体过滤器 Single Cartridge Sanitary Filter

无任何清洗死角过滤器
No dead corner filter

- JTGDX单芯卫生级液体过滤器是一款小流量的高端卫生级过滤器。
- JTGDX单芯卫生级液体过滤器具有良好的表面和最大的耐腐蚀能力，以达到防止细菌污染的质量标准，卫生级过滤器套筒独特的结构，使每一个套筒的内外表面均没有死角，符合“GMP”规范要求，可完全拆洗，操作方便。
- JTGDX Single Fluid Sanitary Filter is high quality sanitary grade filter which service for small flow rate.
- JTGDX Single Fluid Sanitary Filter have excellent surface treatment and the maximal corrosion-resistant in order to prevent the bacterial contamination. The unique structure of the sanitary filter housing ensures inside and outside surface have no dead corner and conforms to the requirements of GMP. The filter housing can be completely disassembled and washed, easy to operate.

典型的应用

- 医药行业：各种抗菌素等药液的前置过滤。
- 食品饮料业：酒类、矿泉水、饮用水的过滤。
- 石油工业：油田注水过滤。
- 电子工业：高纯水前置过滤。
- 化学工业：各种有机溶剂、酸、碱液的过滤。

Application

- Low the pharmaceutical industry: all kinds of antibiotics such as liquid prefiltering.
- Low food and beverage, wine, mineral water, drinking water filtration.
- Low oil industry, oil field water injection filter.
- Low electronic industry: high pure water prefiltering.
- Low chemical industry: all kinds of organic solvents, acid, alkali liquor filtration.

产品特点

- 超高的抛光等级，内壁采用达到 $0.3\mu\text{m}$ ，外壁达到 $0.4\mu\text{m}$ ，绝对卫生级抛光。
- 采用强力快装，最高压力可达 0.6MPa 、 1.0MPa 。
- 排气阀和排液阀：螺纹套和宝塔接头脱离，在放气和排液时，所接软管不会再随着转动。
- 过滤器的支脚采用加强螺纹，不易滑牙，更为耐用；在支脚底部可安装调节螺母，可进行过滤器的高度调节，方便使用。



常规结构 Structure

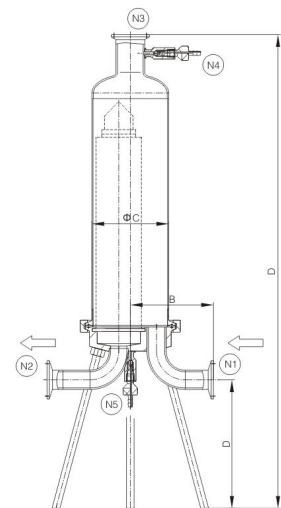

单芯卫生级液体过滤器(222型、226型)
Single fluid sanitary filter housing(222type、226type)

操作条件 Operating Conditions

最大操作压力 Max operating pressure	0.6MPa、1.0MPa
最大操作温度 Max operating temperature	150°C
灭菌 Disinfect	在线或蒸汽灭菌：121°C/30min Online or steam sterilization: 121°C/30min

材料 Material

过滤器壳体 Shell	304、316L、双相钢、钛材、哈氏合金
排气/液阀 Vent/ Drain valve	304
快装、支脚 Quick-open, Stabilizer blade	304
密封圈、垫片 O-ring	三元乙丙橡胶、聚四氟乙烯、氟橡胶、硅橡胶 EPDM, PTFE, Viton, Silicone

连接 Connection

壳体连接 Connection of shell	快装 Tri-clamp
进出口N1、N2 In-outlet	快装 Tri-clamp
压力表(选配) N3 Pressure gauge (option)	1.5"卡接 Tri-clamp
排气阀N4(选配) N4 Vent valve (option)	M6 Thread
排液阀N5(选配) N5 Drain valve (option)	M6 Thread
滤芯接头形式 Cartridges connection	222type, 226type

表面处理 Surface Finish

处理类型 Finish type	机械抛光、电解抛光、喷砂 Mechanical/ Electrolytical polishing Sand blasting
抛光精度 Polishing precision	内壁 $0.3\mu\text{m}$ Inner surface Ra $\leq 0.3\mu\text{m}$ 外壁 $0.4\mu\text{m}$ Outside surface Ra $\leq 0.4\mu\text{m}$

尺寸参数表 Dimension Parameters

	1芯 Pc		
	10"	10"	10"
A: 总高(不含压力表) Total height	625	625	625
B: 进口中心距 The distance from inlet to center		110	
C: 直径 Shell diameter		$\Phi 101.6$	
D: 进口N1、N2离地高度 D: N1, N2 The height from in-outlet to ground		170	
进出口 In-outlet N1、N2尺寸 Size		1"	

上表数据为标准型，仅供参考，可根据客户要求定制；未注长度单位为mm。
The above-mentioned data is the standard, it can customize according to customer's requirements.

JTGDX 选型表 Selection Table

[滤芯数量 Qty. of cartridge]	[滤芯型号 Model of cartridge]	[滤芯接头 Cartridges connection]	[壳体材料 Shell Material]	[进出口连接 In-outlet connection]	[密封圈 O-ring]
1R	20	S	4	K	E
1R=1芯 Pc	10=10" 滤芯 Cartridge	S=226型 Type	4= 304	K=快装 Tri-clamp	E=三元乙丙橡胶 EPDM
	20=20" 滤芯 Cartridge	T=222型 Type	6= 316L		P=聚四氟乙烯 PTFE
	30=30" 滤芯 Cartridge		D=双相钢 Duplex SS		V=氟橡胶 Viton
	40=40" 滤芯 Cartridge		T=钛材 Titanium		S=硅橡胶 Silicone
			H=哈氏合金 Hastelloy		

JTGLD 多芯液体过滤器 Multi Cartridge Sanitary Filter

中小流量的卫生级过滤器
Medium & small flow rate
sanitary filter

- JTGLD多芯液体过滤器，可满足中小流量要求。
- 整体结构(222型、226型)按照卫生级要求设计制造；结构无卫生死角，符合“GMP”规范要求，易清洗；排液彻底，无残余顾虑。
- 对于部分清洗非常苛刻的应用，可将过滤器的花盘做成拆卸式，实现全角度清洗。
- JTGLD Multi Fluid Sanitary Filter can meet requirement of medium & small flow rate.
- The structure design and manufacture in accordance with the sanitary grade. It's no dead corner, meet "GMP" standard, easy to clean, drain thoroughly, no residual liquid.
- For the application of some very harsh cleaning, the filter faceplate made of detachable, full angle cleaning.

典型的应用

- 医药行业：各种抗菌素等药液的过滤。
- 食品饮料业：酒类、矿泉水、饮用水的过滤。
- 石油工业：油田注水过滤。
- 电子工业：高纯水过滤。
- 化学工业：各种有机溶剂、酸、碱液的过滤。

Application

- Pharmaceutical industry: all kinds of antibiotics and other liquid filtration.
- Food and beverage industry: wine, mineral water, drinking water filtration.
- Oil industry: oil field water injection filtration.
- Electronics industry: high purity water filtration.
- Chemical industry: all kinds of organic solvent, acid, lye filtration.

产品特点

- 超高的抛光等级，内壁采用达到 $0.3\mu\text{m}$ ，外壁达到 $0.4\mu\text{m}$ ，绝对卫生级抛光。
- 排气阀可选快装形式，可完全拆卸，无卫生死角。
- 小规格过滤器在支脚底部安装调节螺母，可进行过滤器的高度调节，方便使用。



Feature

- The ultra high level of polishing, the inner surface polished to $0.3\mu\text{m}$ Ra, the outer surface to reach $0.4\mu\text{m}$ Ra, the absolute hygienic level polishing.
- The vent valve can choose quick-open, can completely disassembled and no dead corner of cleaning.
- Small specification filter installation adjusting nut at the bottom of the Stabilizer blade, can adjust the height of the filter, easy to use.



常规结构 Structure

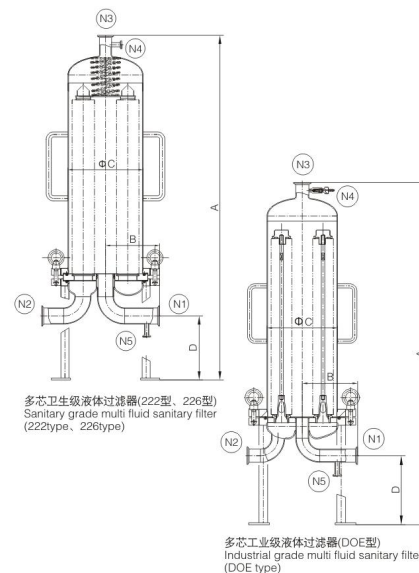

操作条件 Operating Conditions

最大操作压力 Max operating pressure	0.6MPa、1.0MPa
最大操作温度 Max operating temperature	150℃
灭菌(卫生级) Disinfect(sanitation)	在线或蒸汽灭菌: 121℃/30min Online or steam sterilization: 121℃/30min

材料 Material

过滤器壳体 Shell	304、316L、双相钢、钛材、哈氏合金 304、316L、Duplex SS, Titanium, Hastelloy
排气/液阀 Vent/ Drain valve	304
吊环螺栓 Eyebolt	304
密封圈、垫片 O-ring	三元乙丙橡胶、聚四氟乙烯、 氟橡胶、硅橡胶 EPDM, PTFE, Viton, Silicone

连接 Connection

壳体连接 Connection of shell	法兰(吊环螺栓)，卡接 Tri-clamp, Flange
进出口 N1、N2 In-outlet	快装 Tri-clamp
压力表N3(选配) N3 Pressure gauge (option)	1.5"快装 Tri-clamp
排气阀N4(选配) N4Vent valve (option)	1/2"快装/螺纹 1/2"Tri-clamp/M6 Thread
排液阀N5(选配) N5 Drain valve (option)	1/2"快装 Tri-clamp
滤芯接头形式 Cartridges connection	222型、226型(卫生级)DOE(工业级) 222type、226 type (sanitation) DOE type (industrial-grade)

表面处理 Surface Finish

处理类型 Finish type	机械抛光、电解抛光、喷砂 Mechanical/ Electrolytical polishing Sand blasting
抛光精度 Polishing precision	内壁 $0.3\mu\text{m}$ Inner surface Ra $\leq 0.3\mu\text{m}$ 外壁 $0.4\mu\text{m}$ Outside surface Ra $\leq 0.4\mu\text{m}$

尺寸参数表 Dimension Parameters

	3芯(4芯) 3R(4R)				5芯(6芯) 5R(6R)				7芯(8芯) 7R(8R)			
	10"	20"	30"	40"	10"	20"	30"	40"	10"	20"	30"	40"
A ₂ : 总高(不含压力表) Total height	760	1010	1260	1510	780	1030	1280	1530	805	1055	1305	1555
B: 进口中心距 The distance from inlet to center	160				160				200			
C: 直径 Shell diameter	Φ204				Φ235				Φ273			
D: 进出口N1/N2离地高度 The height from in-outlet N1, N2 to the ground	200				200				200			
N1、N2进出口尺寸 In-outlet N1、N2 size	1.5"				2"				2.5"			

上表数据为标准型多芯卫生级液体过滤器，仅供参考，可根据客户要求定制，未注长度单位为mm。
The above-mentioned data is the standard, it can customize according to customer's requirements.

JTGLD 选型表 Selection Table

[滤芯数量 Qty. of cartridge]	[滤芯型号 Model of cartridge]	[滤芯接头 Cartridges connection]	[壳体材料 Shell Material]	[进出口连接 In-outlet connection]	[密封圈 O-ring]
5R	20	S	4	K	E
3R=3芯 Pcs	10=10" 滤芯 Cartridge	S=226型(卫生级) (sanitary grade)	4=304	K=快装 Tri-clamp	E=三元乙丙橡胶 EPDM
5R=5芯 Pcs	20=20" 滤芯 Cartridge	T=222型(卫生级) (sanitary grade)	6=316L		P=聚四氟乙烯 PTFE
7R=7芯 Pcs	30=30" 滤芯 Cartridge	D=DOE(工业级) (industrial grade)	D=双相钢 Duplex SS		V=氟橡胶 Viton
9R=9芯 Pcs	40=40" 滤芯 Cartridge		T=钛材 Titanium		S=硅橡胶 Silicone
12R=12芯 Pcs			H=哈氏合金 Hastelloy		

JTGJM 精密液体过滤器 Precision Liquid Filter

大流量的卫生级过滤器
High flow sanitary filter

- JTGJM精密液体过滤器是大流量多芯卫生级液体过滤器，可满足不同大小的流量要求。
- 整体结构按照卫生级要求设计制造；结构无卫生死角、符合“GMP”规范要求，易清洗；排液彻底，无残液顾虑。
- 对于部分清洗非常苛刻的应用，可将过滤器的花盘做成拆卸式，实现全角度清洗。
- JTGJM Precision liquid filter is a large flow and multi cartridges sanitary liquid filter, can meet the requirements of different sizes of flow rate.
- The structure design and manufacture is in accordance with the sanitary grade. There is no dead corner, meeting "GMP" standard. This product is easy to clean, draining thoroughly, no residual liquid.
- For strict cleaning application, the filter face plate can be designed to be disassembled to achieve full angle cleaning.



产品特点

- 超高的抛光等级，内壁采用达到 $0.3\mu\text{m}$ ，外壁达到 $0.4\mu\text{m}$ ，绝对卫生级抛光。
- 处理流量大，紧凑设计节约空间。
- 侧进底出的设计确保液体介质可被完全排放，同时采用了正切位出口供选择，使得排污彻底，工人操作方便。
- 15芯以上过滤器壳体可采用转臂+吊环螺栓设计或快开设计，操作方便，经济实用。

Feature

- The ultra high level of polishing, the inner surface polished to $0.3\mu\text{m}$ Ra, the outer surface to reach $0.4\mu\text{m}$, the absolute hygienic level polishing.
- Dealing with large flow, compact design saves space
- The design of side in bottom out ensures that the particles can be completely removed. At the same time, tangent outlet makes sewage discharged thoroughly, and workers operate easily.
- For more than 15 cartridges filter housing, the swing arm and eyebolt or quick open are optional design to operate easily. Also it is a economical and practical design.



常规结构 Structure

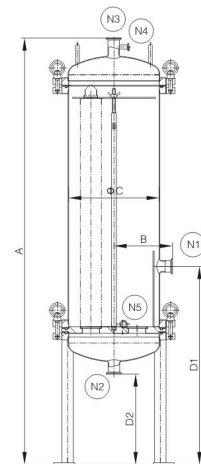

精密液体过滤器(滤芯数量≤12芯)
滤芯型号为30°滤芯(左图示)
Precision Liquid Filter(cartridge quantity ≤ 12pcs)
Cartridge model 30° (left picture)

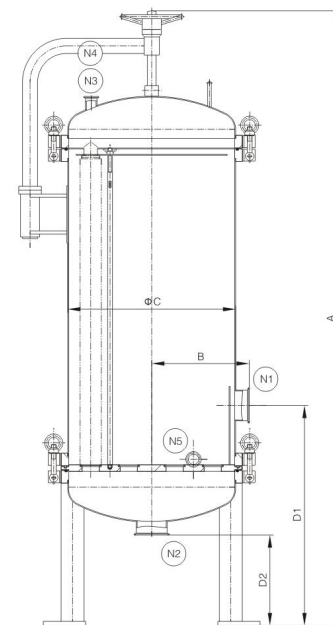

带转臂精密液体过滤器(滤芯数量≥15芯)
滤芯型号为40°滤芯(右图示)
With rotary precision liquid filter(cartridge quantity ≥ 15pcs)
Cartridge model 40° (right picture)

典型的应用

- 医药行业：各种抗菌素等药液的过滤。
- 食品饮料业：酒类、矿泉水、饮用水的过滤。
- 石油工业：油田注水过滤。
- 电子工业：高纯水过滤。
- 化学工业：各种有机溶剂、酸、碱液的过滤。

Application

- Pharmaceutical industry: all kinds of antibiotics and other liquid filtration.
- Food and beverage industry: wine, mineral water, drinking water filtration.
- Oil industry: oil field water injection filtration.
- Electronics industry: high purity water filtration.
- Chemical industry: all kinds of organic solvent, acid, lye filtration.

JTGJM 精密液体过滤器 Precision Liquid Filter

操作条件 Operating Conditions

最大操作压力 Max operating pressure	0.6MPa、1.0MPa
最大操作温度 Max operating temperature	150℃
灭菌 Disinfect	在线或蒸汽灭菌：121℃/30min Online or steam sterilization; 121℃/30min

材料 Material

过滤器壳体 Shell	304、316L、双相钢、钛材、哈氏合金 304、316L、Duplex SS、Titanium、Hastelloy
排气/液阀 Vent/ Drain valve	304、316L
吊环螺栓 Eyebolt	304
支脚 Stabilizer blade	304
密封圈、垫片 O-ring	三元乙丙橡胶、聚四氟乙烯、 氟橡胶、硅橡胶 EPDM、PTFE、Viton、Silicone

JTGJM 选型表 Selection Table

[滤芯数量 Qty. of cartridge]		[滤芯型号 Model of cartridge]	[滤芯接头 Cartridges connection]	[壳体材料 Shell Material]	[进出口连接 In-outlet connection]	[密封圈 O-ring]
12R		20	S	4	K	E
3R=3芯 Pcs	21R=21芯 Pcs	20=20" 滤芯 Cartridge	S=226型 Type	4= 304	K=快装 Tri-clamp	E=三元乙丙橡胶 EPDM
5R=5芯 Pcs	24R=24芯 Pcs	30=30" 滤芯 Cartridge	T=222型 Type	6= 316L		P=聚四氟乙烯 PTFE
7R=7芯 Pcs	36R=36芯 Pcs	40=40" 滤芯 Cartridge		D=双相钢 Duplex SS		V=氟橡胶 Viton
8R=8芯 Pcs	42R=42芯 Pcs			T=钛材 Titanium		S=硅橡胶 Silicone
9R=9芯 Pcs	48R=48芯 Pcs			H=哈氏合金 Hastelloy		
12R=12芯 Pcs	56R=56芯 Pcs					
15R=15芯 Pcs						

表面处理 Surface Finish

处理类型 Finish type	机械抛光、电解抛光、喷砂 Mechanical / Electrolytical polishing Sand blasting
抛光精度 Polishing precision	内径 0.3 μm Inner surface Ra≤0.3 μm 外径 0.4 μm Outside surface Ra≤0.4 μm

连接 Connection

壳体连接 Connection of shell	法兰(吊环螺栓) Flange (Eyebolt)
进出口N1、N2 In-outlet	快装 Tri-clamp
压力表N3(选配) N3 Pressure gauge (option)	1.5"快接 Tri-clamp
排气阀N4(选配) N4 Vent valve (option)	1/2"快装(12芯以下) 1/2" Tri-clamp (less than 12pcs) 1.5"快装(15芯以上) 1.5" Tri-clamp (more than 15pcs)
排液阀N5(选配) N5 Drain valve (option)	1/2"快装(3芯) 1/2" Tri-clamp(3R) 3/4"快装(5芯到12芯) 3/4" Tri-clamp(5pcs to 12pcs) 1"快装(15芯以上) 1" Tri-clamp(more than 15pcs)
滤芯接头形式 Cartridges connection	222型、226型 222type, 226type



尺寸参数表 Dimension Parameters

	3芯(4芯) 3R(4R)			5芯(6芯) 5R(6R)		
	20"	30"	40"	20"	30"	40"
A: 总高(不含压力表) Total height	1123	1373	1623	1145	1395	1645
B: 进口中心距 The distance from inlet to center	142			165		
C: 直径 Shell diameter	Φ 204			Φ 250		
D1: 进口N1离地高度 D1: The height from inlet to ground	540			660		
D2: 出口N2离地高度 D2: The height from outlet to ground	300			300		
N1、N2: 进出口尺寸 In-outlet N1、N2 size	1.5"/2"			1.5"/2"/2.5"		
	7芯(7R)			8芯(8R)		
	20"	30"	40"	20"	30"	40"
	1145	1395	1645	1170	1420	1670
	176.5			190		
	Φ 273			Φ 300		
	660			660		
	300			300		
	1.5"/2"/2.5"			1.5"/2"/2.5"/3"		
	9芯(10芯) 9R(10R)			12芯(11芯) 12R(11R)		
	20"	30"	40"	20"	30"	40"
	1170	1420	1670	1170	1420	1670
	202.5			215		
	Φ 325			Φ 350		
	660			660		
	300			300		
	1.5"/2"/2.5"/3"			1.5"/2"/2.5"/3"		
	15芯(18芯) 15R(18R)	21芯 (21R)	24芯(27芯) 24R(27R)	36芯 (36R)	42芯 (42R)	48芯(54芯) 48R(54R)
	40"	40"	40"	40"	40"	40"
	1947	1959	2026	2036	2044	2067
	240	265	290	315	340	365
	Φ 400	Φ 450	Φ 500	Φ 550	Φ 600	Φ 650
	682	694	714	729	734	744
	300			300		
	3"/3.5"/4"			3"/3.5"/4"		

上表数据为标准型，仅供参考，可根据客户要求定制；未注长度单位为mm。
The above-mentioned data is the standard, it can customize according to customer's requirements.

JTGDG 单芯工业级液体过滤器 Casting Single Cartridge Filter

铸造式，易更换，单芯过滤器
Casting type, easy to replace,
single round filter

- JTGDG单芯工业级液体过滤器，顶部采用一体式铸造式结构，采用上进上出设计，配以转接头，可以直接连接到管路上，安装极其方便。
- 滤筒采用卫生级滤筒，抛光精度 $Ra < 0.6 \mu m$ ，适用于各类过滤要求。
- JTGDG单芯工业级液体过滤器采用极其紧凑的结构设计，顶部可以固定在管路上；换芯时，只需将滤筒打开即可，整个过程无料液渗出。
- 底部配以排液阀，方便料液的排放。
- ZJTGDG Single Fluid Industrial Filter adopts the integrated casting top structure. Based on top in top out design, with the adaptor, it can be directly connected to the pipeline, the installation is extremely easy.
- The filter housing is sanitary grade, polishing precision $Ra < 0.6 \mu m$ suitable for many kinds of filter requirements
- JTGDG Single Fluid Industrial Filter adopts very compact structure design, and the top can be fixed in the pipeline. When you exchange the cartridges, just open the filter housing. There is no liquid leakage in whole process.
- Drain valve at the bottom is convenient for operator to discharge liquid.



产品特色

- 上进上出，可直接连接到管路上。
- 更换滤芯简便，无料液渗出。
- 底部装有排液阀，方便排放。
- 安全的密封性设计。

典型的应用

- 水处理：各种水质的过滤。
- 食品饮料业：酒类、矿泉水、饮用水的过滤。
- 化学工业：各种有机溶剂、酸、碱液的过滤。

Feature

- The filter is top entry & top out structure, Can be directly connected to the pipeline.
- It's easy to change cartridge, and no liquid leakage.
- Drain valve at the bottom. It's convenient for operator to discharge liquid.
- Safety seal design.

Application

- Water Finish: all kinds of water filtration.
- Food & beverage: wine, mineral water, drinking water filtration.
- Chemical industry: all kinds of organic solvents, acid, alkali, filtration.



常规结构 Structure

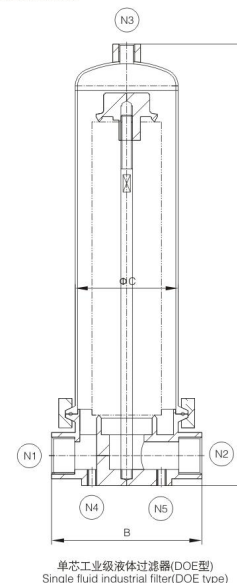

操作条件 Operating Conditions

最大操作压力 Max operating pressure	0.6MPa、1.0MPa
最大操作温度 Max operating temperature	150°C

材料 Material

过滤器壳体 Shell	304、316L、双相钢、钛材、哈氏合金 304、316L、Duplex SS, Titanium, Hastelloy
排液阀 Drain valve	304
密封圈、垫片 O-ring	三元乙丙橡胶、聚四氟乙烯、 氟橡胶、硅橡胶 EPDM, PTFE, Viton, Silicone

连接 Connection

壳体连接 Connection of shell	快装、螺纹 Quick-open, screw thread
进出口 N1、N2 In-outlet	1"螺纹 1" thread
压力表N3(选配) N3 Pressure gauge (option)	1/4"螺纹 1/4" thread
排气阀N4(选配) N4 Vent valve (option)	1/4"螺纹 1/4" thread
滤芯接头形式 Cartridges connection	DOE型 DOE Type

表面处理 Surface Finish

处理类型 Finish type	基座：铸造 筒体：机械抛光、电解抛光、喷砂 Base: Cast Shell: Mechanical/electrolytic polishing, sand blasting
抛光精度 Polishing precision	内壁 $0.6 \mu m$ Inner surface $Ra \leq 0.3 \mu m$ 外壁 $0.8 \mu m$ Outside surface $Ra \leq 0.4 \mu m$

尺寸参数表 Dimension Parameters

	1芯 (1R)		
	10"	10"	10"
A: 总高(不含压力表) Total height	625	625	625
B: 进口中心距 The distance from inlet to center		110	
C: 直径 Shell diameter		$\Phi 101.6$	
进出口 In-outlet N1、N2尺寸 Size	1" 螺纹 Thread		

上表数据为标准型，仅供参考，可根据客户要求定制；未注长度单位为mm。
The above-mentioned data is the standard, it can customize according to customer's requirements.

JTGDG 选型表 Selection Table

[滤芯数量 Qty. of cartridge]	[滤芯型号 Model of cartridge]	[滤芯接头 Cartridges connection]	[壳体材料 Shell Material]	[进出口连接 In-outlet connection]	[密封圈 O-ring]
1R=1芯 Pcs	20	D	4	K	E
	10=10" 滤芯 Cartridge	D=DOE型 Type	4= 304	L=螺纹 Thread	E=三元乙丙橡胶 EPDM
	20=20" 滤芯 Cartridge		6= 316L		P=聚四氟乙烯 PTFE
	30=30" 滤芯 Cartridge		D=双相钢 Duplex SS		V=氟橡胶 Viton
	40=40" 滤芯 Cartridge		T=钛材 Titanium		S=硅橡胶 Silicone
			H=哈氏合金 Hastelloy		

JTGSF 工业级精密过滤器 Industrial Grade Precision Liquid Filter

大流量的工业级过滤器
High flow industrial-grade filter



- JTGSF工业级精密过滤器是专门为工业过滤领域所设计的精密过滤器，可广泛应用于各类化工料液中，满足不同大小的流量要求。
- 采用侧进下出的流体方式，确保在更换滤芯过程中，料液不会溢出，造成污染；过滤器可做三段式结构，筒体上下开口，花盘可拆卸，实现过滤器全可拆卸，特别适用于个别对清洗要求严格的操作环节。
- JTGSF工业级精密过滤器采用多道抛光处理，保证料液接触面Ra达到 $0.6\mu\text{m}$ 接近卫生级要求，全镜面抛光，完全可以应用在高精度料液过滤。
- JTGSF Industrial Grade Precision Liquid Filter is precision filter which is specially designed for industrial field, it can be applied for various chemical materials and meet the requirements of different flow.
- The filter housing using side entry & bottom out flow method, it ensure that the material liquid does not overflow when replace cartridge in process. The filter housing can be design to three-stage structure, shell can be opened from top and bottom, the filter can be absolutely disassemble. For the application of some very harsh cleaning, the filter can full angle cleaning.
- JTGSF Industrial Grade Precision Liquid Filter use many times polishing process, ensure that the material liquid contact surface Ra reached $0.6\mu\text{m}$ close to the sanitary requirement, the filter polished is mirror polished. It can be applied in high precision liquid filtration.

典型的应用

- 水处理：各种水质的过滤。
- 食品饮料业：酒类、矿泉水、饮用水的过滤。
- 化学工业：各种有机溶剂、酸、碱液的过滤。

Application

- Water Finish: all kinds of water filtration.
- Food & beverage: wine, mineral water, drinking water filtration.
- Chemical industry: all kinds of organic solvents, acid, alkali, filtration.

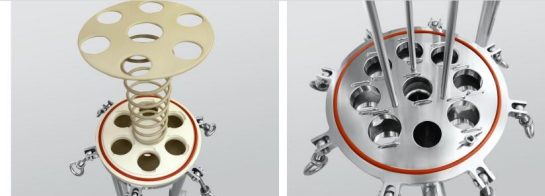

常规结构 Structure

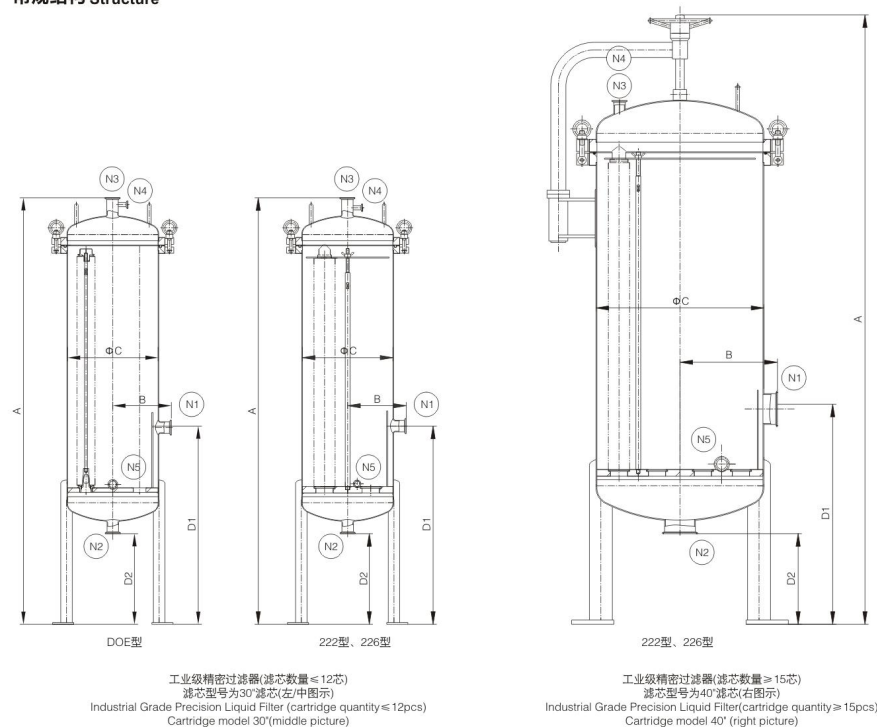

产品特点

- 筒体可做成上下开口的形式，即方便更换滤芯，又能实现侧底清洗。
- 过滤器花盘可做成拆卸式，实现侧底清洗。
- 配有双排液口形式，分别在筒体的花盘上和过滤器的底部，排液方便、侧底。
- 侧进底出的设计确保液体介质可被完全排放，同时采用了正切位出口供选择，使得排污彻底，工人操作方便。
- 15芯以上过滤器壳体可采用转臂+吊环螺栓设计或快开设计，操作方便，经济实用。

Feature

- Filter can be made into the form of top and bottom openings, which is convenient to replace the filter and to clean thoroughly.
- The filter faceplate can be made into a detachable type, to achieve thorough cleaning
- Two drain vents, respectively in the top of the disk and the bottom of the filter, let discharging easy and complete.
- Side in and bottom out, this design ensures that the liquid can be completely discharged. At the same time, tangent outlet makes sewage discharged thoroughly, and workers operate easily.
- For more than 15 cartridges filter housing, the swing arm and eyebolt or quick open are optional design to operate easily. Also it is a economical and practical design.

JTGSF 工业级精密过滤器 Industrial Grade Precision Liquid Filter

操作条件 Operating Conditions

最大操作压力 Max operating pressure	0.6MPa、1.0MPa
最大操作温度 Max operating temperature	150℃

材料 Material

过滤器壳体 Shell	304、316L、双相钢、钛材、哈氏合金 304、316L、Duplex SS、Titanium、Hastelloy
排气/液阀 Vent/ Drain valve	304、316L
吊环螺栓 Eyebolt	304
支脚 Stabilizer blade	304
密封圈、垫片 O-ring	三元乙丙橡胶、聚四氟乙烯、 氟橡胶、硅橡胶 EPDM、PTFE、Viton、Silicone

表面处理 Surface Finish

处理类型 Finish type	机械抛光、电解抛光 Mechanical/ Electrolytical polishing
抛光精度 Polishing precision	内壁 0.6 μm Inner surface Ra≤0.6 μm 外壁 0.8 μm Outside surface Ra≤0.8 μm

连接 Connection

壳体连接 Connection of shell	法兰(吊环螺栓) Flange (Eyebolt)
进出口N1、N2 In-outlet	快装 Tri-clamp
压力表N3(选配) N3 Pressure gauge (option)	1.5"快接 Tri-clamp
排气阀N4(选配) N4Vent valve (option)	1/2"快装(12芯以下) 1/2"Tri-clamp (less than 12pcs) 1.5"快装(15芯以上) 1.5"Tri-clamp (more than 15pcs)
排液阀N5(选配) N5 Drain valve (option)	1/2"快装(3芯)1/2" Tri-clamp(3R) 3/4"快装(5芯到12芯) 3/4" Tri-clamp(5pcs to12pcs) 1"快装(15芯以上) 1" Tri-clamp(more than 15pcs)
滤芯接头形式 Cartridges connection	222/226型/DOE 222type, 226type, DOE

JTGSF 选型表 Selection Table

〔 滤芯数量 Qty. of cartridge 〕		〔 滤芯型号 Model of cartridge 〕	〔 滤芯接头 Cartridges connection 〕	〔 壳体材料 Shell Material 〕	〔 进出口连接 In-outlet connection 〕	〔 密封圈 O-ring 〕
12R		20	S	4	K	E
3R=3芯 Pcs	21R=21芯 Pcs	20=20" 滤芯 Cartridge	S=226型 Type	4= 304	K=快装 Tri-clamp	E=三元乙丙橡胶 EPDM
5R=5芯 Pcs	24R=24芯 Pcs	30=30" 滤芯 Cartridge	T=222型 Type	6= 316L	E=法兰 Flange	P=聚四氟乙烯 PTFE
7R=7芯 Pcs	36R=36芯 Pcs	40=40" 滤芯 Cartridge	D=DOE型 Type	D=双相钢 Duplex SS	L=螺纹 Screw thread	V=氟橡胶 Viton
8R=8芯 Pcs	42R=42芯 Pcs			T=钛材 Titanium		S=硅橡胶 Silicone
9R=9芯 Pcs	48R=48芯 Pcs			H=哈氏合金 Hastelloy		
12R=12芯 Pcs	56R=56芯 Pcs					
15R=15芯 Pcs						

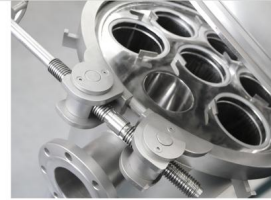

尺寸参数表 Dimension Parameters

	3芯(4芯) 3R(4R)			5芯(6芯) 5R(6R)		
	20"	30"	40"	20"	30"	40"
A: 总高(不含压力表) Total height	1123	1373	1623	1145	1395	1645
B: 进口中心距 The distance from inlet to center	142			165		
C: 直径 Shell diameter	Φ 204			Φ 250		
D1: 进口N1离地高度 D1: The height from inlet to ground	540			660		
D2: 出口N2离地高度 D2: The height from outlet to ground	300			300		
N1、N2: 进出口尺寸 In-outlet N1、N2 size	1.5"/2"			1.5"/2"/2.5"		
	7芯(7R)			8芯(8R)		
	20"	30"	40"	20"	30"	40"
	1145	1395	1645	1170	1420	1670
	176.5			190		
	Φ 273			Φ 300		
	660			660		
	300			300		
	1.5"/2"/2.5"			1.5"/2"/2.5"/3"		
	9芯(10芯) 9R(10R)			12芯(11芯) 12R(11R)		
	20"	30"	40"	20"	30"	40"
	1170	1420	1670	1170	1420	1670
	202.5			215		
	Φ 325			Φ 350		
	660			660		
	300			300		
	1.5"/2"/2.5"/3"			1.5"/2"/2.5"/3"		
	15芯(18芯) 15R(18R)	21芯 (21R)	24芯(27芯) 24R(273R)	36芯 (36R)	42芯 (42R)	48芯(54芯) 48R(54R)
	40"	40"	40"	40"	40"	40"
	1947	1959	2026	2036	2044	2067
	240	265	290	315	340	365
	Φ 400	Φ 450	Φ 500	Φ 550	Φ 600	Φ 650
	682	694	714	729	734	744
		300			300	
	3"/3.5"/4"			3"/3.5"/4"		

上表数据为标准型222型、226型工业级精密过滤器，仅供参考。可根据客户要求定制，未注长度单位为mm。
The above-mentioned data is the standard, it can customize according to customer's requirements.

JTGHF 大流量液体过滤器 Large Flow Liquid Filter

超大流量工业级过滤器 Super large industrial-Grade Filter

典型的应用

- 流量较大的场合，特别是水处理领域。

Application

- Mainly used in some large flow situation, especially water treatment field

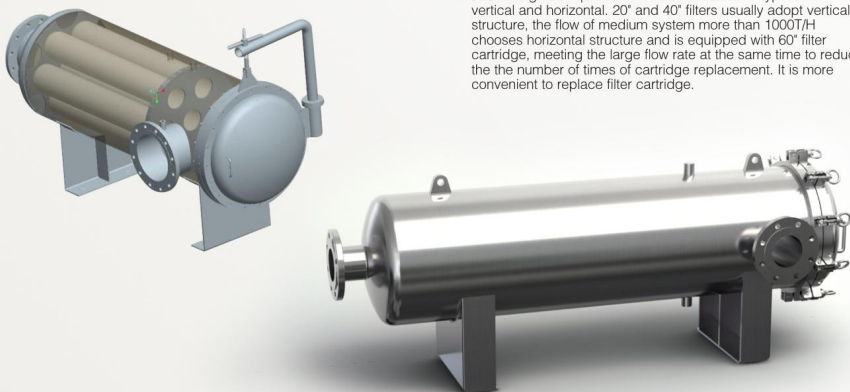

产品特色

- 流量大、占地面积小、效率高。
- 304和316L两种不锈钢可供选择，良好的耐腐蚀性能，能满足各领域要求。
- 立式和卧式两种结构可供选择。

- JTGHF大流量液体过滤器，又名JTGHF大胖过滤器是针对对于大口径和高流速的管道而开发，适用于高通量的工况，其芯件采用折叠式大流量滤芯，相当于传统普通冲孔滤芯和棒式折叠式滤芯多倍面积；其大于50%的开孔率与直通式结构，组合出最大的流量和最小的压差，大大降低了总体的尺寸和重量，从而减少了投资成本及运行成本，也降低滤芯更换的频率，节约了劳动力资源。
- JTGHF大流量液体过滤器分立式和卧式两种，常规20"、40"滤芯的过滤器通常采用立式结构；超过1000吨/小时流量的中大系统，选择卧式结构，并配备60"的滤芯使用，满足大流量的同时，降低滤芯更换次数，更换滤芯更方便。
- JTGHF industrial-grade liquid filter is mainly used in some larger flow situation, especially water treatment field. JTGHF big flow liquid filter characterizes of big connect size, high flux and small occupation area. It can effectively solve the traditional filter problem high costs input, the long replacement time, trouble operation and so on.
- JTGHF big flow liquid filter have two installation types like vertical and horizontal. 20" and 40" filters usually adopt vertical structure, the flow of medium system more than 1000T/H chooses horizontal structure and is equipped with 60" filter cartridge, meeting the large flow rate at the same time to reduce the number of times of cartridge replacement. It is more convenient to replace filter cartridge.

Feature

- Super large flow, small occupation area, high efficiency.
- 304 and 316 L stainless steel are available, good corrosion resistance, meeting the requirements of various fields.
- Vertical and horizontal structures can be chose.



常规结构 Structure

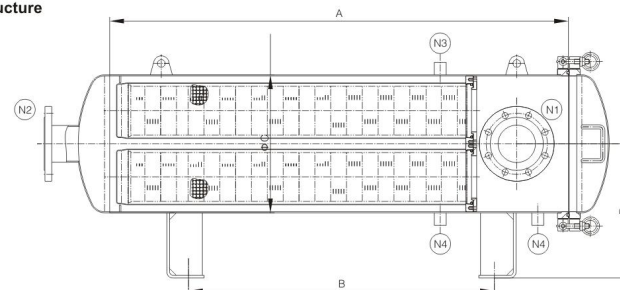

大流量液体过滤器(大胖过滤器) Large flow liquid filter

操作条件 Operating Conditions

最大操作压力 Max operating pressure	0.6MPa、1.0MPa
最大操作温度 Max operating temperature	150℃

材料 Material

过滤器壳体 Shell	304, 316L, 双相钢, 钛材, 哈氏合金 304, 316L, Duplex SS, Titanium, Hastelloy
排气/液阀 Vent/ Drain valve	304, 316L
吊环螺栓 Eyebolt	304
支脚 Stabilizer blade	304
密封圈、垫片 O-ring	三元乙丙橡胶、聚四氟乙烯、氟橡胶、硅橡胶 EPDM, PTFE, Viton, Silicone

表面处理 Surface Finish

处理类型 Finish type	机械抛光、电解抛光 Mechanical/ Electrolytical polishing
抛光精度 Polishing precision	内腔 0.3 μm Inner surface Ra≤0.6 μm 外壁 0.4 μm Outside surface Ra≤0.6 μm

连接 Connection

壳体连接 Connection of shell	法兰 Flange
进出口N1、N2 In-outlet	快装、法兰 Flange, Tri-clamp
压力表N3(选配) N3 Pressure gauge (option)	G3/4"螺纹 Thread
排气阀N4(选配) N4Vent valve (option)	G1/2"螺纹 Thread

尺寸参数表 Dimension Parameters

	1芯 (1R)			2芯 (2R)		
	20"	40"	60"	20"	30"	40"
A: 壳体长度(不含封头) Shell length (exclude head)	700	1200	1700	800	1300	1800
B: 支座固定螺栓孔中心距 Support center distance	300	600	900	400	700	1000
C: 直径 Shell diameter	Φ 230			Φ 400		
D: 进出口N1、N2离地高度 The height form In-outlet N1, N2	355			395		
进出口N1、N2尺寸 In-outlet N1、N2 size	2"/2.5"/3"			3"/4"/5"		

上表数据为标准型大流量液体过滤器(卧式)，可根据客户要求定制，未注长度单位为mm。
The above-mentioned data is the standard, it can customize according to customer's requirements.

JTGHF 选型表 Selection Table

〔 结构形式 〕 Type of construction	〔 滤芯数量 〕 Qty. of cartridge	〔 滤芯型号 〕 Model of Bag Filter	〔 壳体材料 〕 Shell Material	〔 进出口连接 〕 In-outlet connection	〔 密封圈 O-ring 〕
L	2R	20	4	K	E
L=立式 Vertical	1R=1芯 Pcs	20=20" 滤芯 Cartridge	4= 304	K=快装 Tri-clamp	E=三元乙丙橡胶 EPDM
W=卧式 Horizontal	2R=2芯 Pcs	40=40" 滤芯 Cartridge	6= 316L	E=法兰 Flange	P=聚四氟乙烯 PTFE
	3R=3芯 Pcs	60=60" 滤芯 Cartridge	D=双相钢 Duplex SS	L=螺纹 Screw thread	V=氟橡胶 Viton
	4R=4芯 Pcs		T=钛材 Titanium		S=硅橡胶 Silicone
	5R=5芯 Pcs		H=哈氏合金 Hastelloy		

JTGRP 保安过滤器 Security Filter

水处理过滤器
Water treatment precision filter

- JTGRP保安过滤器是专门为水处理领域所设计的保安过滤器。
- JTGRP保安过滤器采用多道抛光处理，保证料液接触面Ra达到 $0.6\mu\text{m}$ 接近卫生级要求，全镜面抛光，完全可以应用在高精度料液过滤。
- JTGRP Security Filter is mainly designed for water treatment field.
- JTGRP Security Filter Housing using multiple polishing process, ensures that the surface Ra reaching $0.6\mu\text{m}$ up to the sanitary grade requirement, the filter surface is mirror polished. It can be applied in high precised liquid filtration.

典型的应用

- 水处理：用于民生生活饮用水过滤.R.O逆渗透过滤。
- 食品饮料业：酒类、矿泉水、饮用水的过滤。

Application

- Water Finish: R.O reverse osmosis filtration for drinking water.
- Food and beverage industry: wine, mineral water, drinking water filtration.

产品特点

- 筒体内外表面采用镜面抛光，料液接触面Ra达到 $0.6\mu\text{m}$ 接近卫生级要求。
- 采用花盘上下排水阀形式，排液方便快捷。
- 滤芯密封面采用弹簧式密封，操作方便。

Feature

- The material liquid contact surface Ra reaching $0.6\mu\text{m}$ closes to the sanitary grade requirement.
- The filter housing has top and bottom drain valve which drain liquid conveniently and quickly.
- Cartridge sealing surface uses spring type sealing. It's easy to Operate.



常规结构 Structure

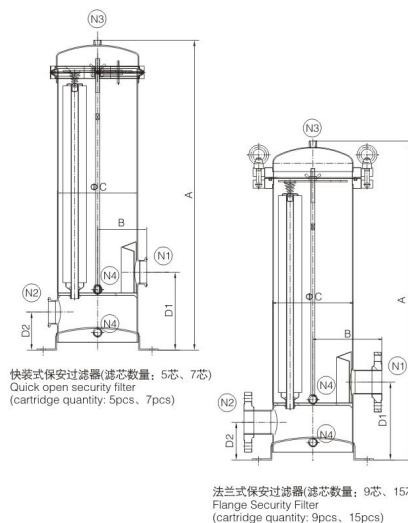

操作条件 Operating Conditions

最大操作压力 Max operating pressure	0.6MPa
最大操作温度 Max operating temperature	140℃

材料 Material

过滤器壳体 Shell	304, 316L, 双相钢, 钛材, 哈氏合金 304, 316L, Duplex SS, Titanium, Hastelloy
排液阀 Vent/ Drain valve	304, 316L
吊环螺栓 Eyebolt	304
密封圈、垫片 O-ring	三元乙丙橡胶, 聚四氟乙烯、 氟橡胶、硅橡胶 EPDM, PTFE, Viton, Silicone

连接 Connection

壳体连接 Connection of shell	快装、法兰(吊环螺栓) Tri-clamp, Flange(Eyebolt)
进出口N1、N2 In-outlet	法兰/快装螺纹 Flange, Tri-clamp, Thread
压力表N3(选配) N3 Pressure gauge (option)	1.5"快装 Tri-clamp
排气阀N4(选配) N4Vent valve (option)	1" 快装、螺纹 Tri-clamp, Thread
滤芯接头形式 Cartridges connection	DOE型、222型 DOE Type, 222 Type

表面处理 Surface Finish

处理类型 Finish type	机械抛光、电解抛光、喷砂 Mechanical/electrolytical polishing, sand blasting
抛光精度 Polishing precision	内壁 $0.6\mu\text{m}$ Inner surface Ra $\leq 0.6\mu\text{m}$ 外壁 $0.8\mu\text{m}$ Outside surface Ra $\leq 0.8\mu\text{m}$

尺寸参数表 Dimension Parameters

	5芯(4芯) 5R(4R)				7芯 7R		
	10"	20"	30"	40"	20"	30"	40"
A: 总高(不含压力表) Total height	570	820	1070	1320	820	1070	1320
B: 进口中心距 The distance from inlet to center	175(法兰) Flange, 125(快装) Tri-clamp, 130(螺纹) Thread				190(法兰) Flange, 140(快装) Tri-clamp, 145(螺纹) Thread		
C: 直径 Shell diameter	$\Phi 204$				$\Phi 235$		
D1: 进口N1离地高度 The height from inlet to ground	178				178		
D2: 出口N2离地高度 The height from outlet to ground	76				76		
N1、N2: 进出口尺寸 In-outlet N1、N2 size	2"				2"		

上表数据为标准型快装式保安过滤器，仅供参考，可根据客户要求定制；未注长度单位为mm。
The above-mentioned data is the standard, it can customize according to customer's requirements.

JTGRP 选型表 Selection Table

[滤芯数量 Qty. of cartridge]	[滤芯型号 Model of cartridge]	[滤芯接头 Cartridges connection]	[壳体材料 Shell Material]	[进出口连接 In-outlet connection]	[密封圈 O-ring]
7R	20	T	4	L	E
5R=5芯(4芯) Pcs	10=10" 滤芯 Cartridge	T=222型 Type	4= 304	F=法兰 Flange	E=三元乙丙橡胶 EPDM
7R=7芯 Pcs	20=20" 滤芯 Cartridge	D=DOE型 Type	6= 316L	K=快装 Tri-clamp	P=聚四氟乙烯 PTFE
9R=9芯 Pcs	30=30" 滤芯 Cartridge		D=双相钢 Duplex SS	L=螺纹 Screw thread	V=氟橡胶 Viton
15R=15芯 Pcs	40=40" 滤芯 Cartridge		T=钛材 Titanium		S=硅橡胶 Silicone
			H=哈氏合金 Hastelloy		

JTGYB 翻转钛棒过滤器 Swing Titanium Rod Fluid Filter

固液分离过滤器 Solid-liquid separation filter

- JTGYB翻转钛棒过滤器，特别为固体杂质含量较高的料液场合设计。配合金属钛滤芯或不锈钢滤芯，可实现良好的固液分离效果；筒身可180° 翻转，可将滤芯外部的固体杂质颗粒侧底排尽。
- 筒体全部采用优质304或316L不锈钢材料制造，筒体采用法兰连接方式；一般用于粗滤或中间过滤。
- 翻转钛棒过滤器能除去清水中的异色，异味和汞、铅、镉、锌、铁、锰、铬等重金属物质，还可去除清水中的砷、氢化物、硫化物、余氯等高分子化合物及锶，镭等放射性物质，除去和杀死水中的细菌和大肠杆菌以及其它致病物质；广泛食品饮料、制药、化工等行业的固液分离，在制药行业尤其适用于输液剂生产线中的脱炭过滤。
- JTGYB Swing Fluid Filter Housing is specially designed for the material liquid with high solid content of impurities. With metal titanium cartridge or stainless steel cartridge, it can achieve an excellent effect of solid liquid separation. The filter shell can turn 180°, the solid impurity on the outside surface of cartridge can be drained completely.
- The filter are all made of high quality 304 or 316L stainless steel materials. The whole shell is connected by flange. Swing type filter mainly used in industrial field decarburization filtration and the high oxidizing solution filtration.
- For water treatment The titanium filter can remove heavy metals like heterochromatic impurity, odor, mercury, lead, cadmium, zinc, iron, manganese and chrome and remove polymers like arsenic, hydride, sulfide, chlorine and other radioactive substances like strontium, radium. What's more, it can remove and kill bacteria and Escherichia coli, and other cancer-causing substances in the water.

产品特点

- 筒身可180° 翻转，可将滤芯外部的固体杂质颗粒侧底排尽。
- 花盘可拆卸，实现侧底清洗。
- 过滤器壳底部可设置轮子，方便移动。
- 钛棒滤芯，具有耐高温、高压、强酸、强碱、耐腐蚀，通过冲洗或酸碱浸泡后可反复再生使用。



Feature

- The filter shell can turn 180°, the solid impurity particles of the cartridge external can be drained completely.
- The filter faceplate can be made into a detachable type, to achieve thorough cleaning.
- We can add wheels at the bottom of the filter shell, convenient to move.
- Titanium rod cartridge has high temperature, high pressure resistance, strong acid, strong alkali, corrosion resistance, it can be used repeatedly after washing or soaking by acid and alkali.

典型的应用

- 电子工业：电子、微电子、半导体工业用水等过滤。
- 医药工业：原料药、溶剂性药液、物料的脱碳过滤等过滤。
- 化学工业：有机溶剂、化学试剂、液体原料、催化剂等过滤。
- 食品工业：啤酒、饮料、矿泉水、植物油、酱油、醋等过滤。
- 炼油工业：油田回流水过滤、海水淡化领域反渗透前的保安过滤。

常规结构 Structure

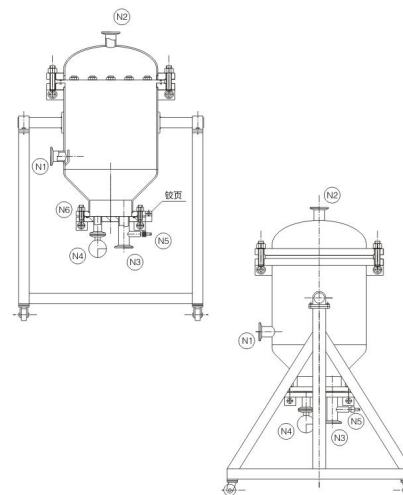

翻转钛棒过滤器
Swing titanium rod fluid filter

Application

- Electronics industry: electronic, microelectronics, semiconductor industry water filtration.
- Pharmaceutical industry: pharmaceutical raw materials, solvent liquid medicine, decarbonize material filtration.
- Chemical industry: organic solvents, chemical reagents, liquid raw materials, catalysts, etc. filtration.
- Food industry: beer, beverage, mineral water, vegetable oil, soy sauce, vinegar, etc. filtration.
- Oil refining industry: oilfield reflux water filtration, industry filtration before reverse osmosis desalination field.

操作条件 Operating Conditions

最大操作压力 Max operating pressure	0.6MPa
最大操作温度 Max operating temperature	200°C

材料 Material

过滤器壳体 Shell	304, 316L, 双相钢, 钛材, 哈氏合金 304, 316L, Duplex SS, Titanium, Hastelloy
排气/液阀 Vent/ Drain valve	304, 316L
吊环螺栓 Eyebolt	304
支脚 Stabilizer blade	304
密封圈、垫片 O-ring	三元乙丙橡胶, 聚四氟乙烯, 氟橡胶, 硅橡胶 EPDM, PTFE, Viton, Silicone

连接 Connection

壳体连接 Connection of shell	法兰(吊环螺栓) Flange(Eyebolt)
进出口 N1, N2 In-outlet	快装法兰螺纹 Tri-clamp, Flange, Thread
排污阀 N3 N3 Drain valve(option)	快装 Tri-clamp
压力表 N4(选配) N4 Pressure gauge (option)	快装 Tri-clamp
排气阀 N5(选配) N5 Vent valve (option)	螺纹 Thread
排渣阀 N6 N6 Discharge valve	快开法兰带翅 Quick opening flange with hinges

表面处理 Surface Finish

处理类型 Finish type	机械抛光 Mechanical polishing
抛光精度 Polishing precision	内壁 0.4 μm Inner surface Ra≤0.4 μm 外壁 0.4 μm Outside surface Ra≤0.6 μm

JTGYB 选型表 Selection Table

〔 钛棒滤芯数量 Qty. Of Titanium cartridge 〕	〔 滤芯型号 Model of cartridge 〕	〔 壳体材料 Shell Material 〕	〔 进出口连接 In-outlet connection 〕	〔 密封圈 O-ring 〕
5T	20	4	K	E
3T=3芯Pcs	10=10' 滤芯 Cartridge	4= 304	F=法兰 Flange	E=三元乙丙橡胶 EPDM
5T=5芯 Pcs	20=20' 滤芯 Cartridge	6= 316L	K=快装 Tri-clamp	P=聚四氟乙烯 PTFE
9T=9芯 Pcs	30=30' 滤芯 Cartridge	D=双相钢 Duplex SS	L=螺纹 Screw thread	V=氟橡胶 Viton
	40=40' 滤芯 Cartridge	T=钛材 Titanium		S=硅橡胶 Silicone
		H=哈氏合金 Hastelloy		

JTGTB 金属精密过滤器 Metal Precision Cartridge Filter

金属粉末反冲洗过滤器 Metal powder back flush filter housing

- JTGTB金属精密过滤器，适合过滤高温高压、高固含量的物料。过滤器采用反吹清洗方式，可连续自动化操作，避免了频繁的人工清洗和不必要的停车；且最大化减少了滤芯及残液对环境造成的污染。
- 金属精密过滤器能除去水中的异色，异味和汞、铅、镉、铊、铁、锰、铬等重金属物质，还可去除水中的砷、氢化物、硫化物、余氯等高分子化合物及锑，镉等放射性物质，除去和杀死水中的细菌和大肠杆菌以及其它致癌物质；广泛食品饮料、制药、化工等行业的固液分离，在制药行业尤其适用于输液剂生产中的脱炭过滤。
- JTGTB Metal precision filter, suitable for filtering the high temperature and high pressure, high solid content of the material. Filter using reverse cleaning method, can be continuous automation, to avoid the frequent manual cleaning and unnecessary parking; And maximal decrease the pollution of filter material and the residual liquid to the environment.
- Metal precision filter can remove water in different color, odor and mercury, lead, cadmium, zinc, iron, manganese, chromium, and other heavy metal material, also can remove the arsenic in the water, and hydride, sulphide, residual chlorine and other high molecular compound and strontium, radium and other radioactive substances, remove and kill the bacteria and e. coli and other carcinogens in the water. Food and beverage, pharmaceutical, chemical and other industries of solid-liquid separation, especially in the pharmaceutical industry is suitable for the decarbonization filtration of transfusion injection production line.



产品特点

- 金属滤芯，主要钛棒滤芯，具有耐高温、高压、强酸、强碱、耐腐蚀，通过冲洗或酸碱浸泡后可反复再生使用。

典型的应用

- 电子工业：电子、微电子、半导体工业用水等过滤。
- 医药工业：原料药、溶剂性药液、物料的脱炭过滤等过滤。
- 化学工业：有机溶剂、化学试剂、液体原料、催化剂等过滤。
- 食品工业：啤酒、饮料、矿泉水、植物油、酱油、醋等过滤。
- 炼油工业：油田回流水过滤、海水淡化领域反渗透前的保安过滤。

Feature

- Metal filter cartridge, mainly Titanium rod cartridge has high temperature, high pressure resistance, strong acid, strong alkali, corrosion resistance, it can be used repeatedly after washing or soaking by acid and alkali

Application

- Electronics industry: electronic, microelectronics, semiconductor industry water filtration.
- Pharmaceutical industry: pharmaceutical raw materials, solvent liquid medicine, decarbonize material filtration.
- Chemical industry: organic solvents, chemical reagents, liquid raw materials, catalysts, etc. filtration.
- Food industry: beer, beverage, mineral water, vegetable oil, soy sauce, vinegar, etc. filtration.
- Oil refining industry: oilfield reflux water filtration, industry filtration before reverse osmosis desalination field.

常规结构 Structure

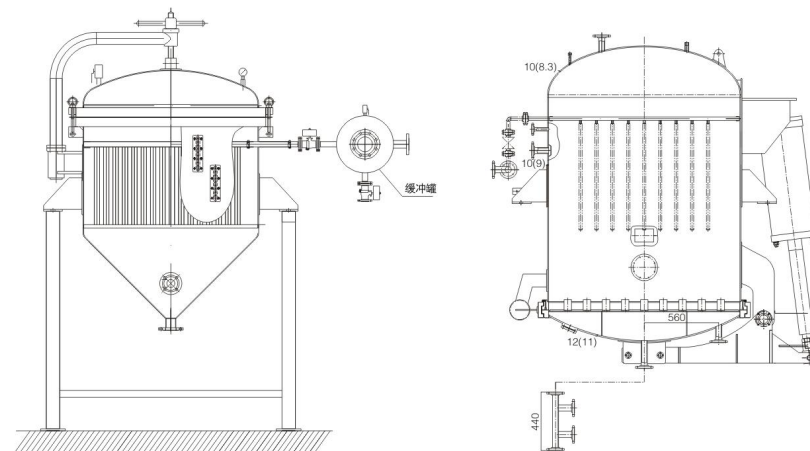

金属精密过滤器 Metal precision filter housing

操作条件 Operating Conditions

最大操作压力 Max operating pressure	0.6MPa
最大操作温度 Max operating temperature	200°C

材料 Material

过滤器壳体 Shell	304, 316L, 双相钢, 钛材, 哈氏合金
排气/液阀 Vent/ Drain valve	304, 316L
吊环螺栓 Eyebolt	304
支脚 Stabilizer blade	304
密封圈、垫片 O-ring	三元乙丙橡胶、聚四氟乙烯、氟橡胶、硅橡胶 EPDM, PTFE, Viton, Silicone

表面处理 Surface Finish

处理类型 Finish type	机械抛光 Mechanical polishing
抛光精度 Polishing precision	内壁 0.4 μm Inner surface Ra ≤ 0.4 μm 外壁 0.4 μm Outside surface Ra ≤ 0.6 μm

连接 Connection

壳体连接 Connection of shell	法兰(吊环螺栓) Flange(Eyebolt)
进出口 In-outlet	快装/法兰螺纹 Tri-clamp, Flange, Thread
排污阀 Drain valve	快装 Tri-clamp
压力表(选配) Pressure gauge (option)	螺纹、快装 Thread, Tri-clamp
排气阀 Vent valve	螺纹 Thread
排渣 Slagging	气动控制自锁型排渣门、快装 Pneumatic control self-locking type discharge door, quick loading

JTGTB 选型表 Selection Table

壳体直径 Diameter of shell	壳体材料 Shell Material	进出口连接 In-outlet connection	密封圈 O-ring
1000T	4	K	S
1000T=直径Φ1000钛棒过滤(下同)	4=304	F=法兰 Flange	E=三元乙丙橡胶 EPDM
1300T	6=316L	K=快装 Tri-clamp	P=聚四氟乙烯 PTFE
1800T	D=双相钢 Duplex SS	L=螺纹 Screw thread	V=氟橡胶 Viton
2500T	T=钛材 Titanium		S=硅橡胶 Silicone
	H=哈氏合金 Hastelloy		

JTGLL 篮式过滤器 Basket Strainer

滤网式管道过滤器
Mesh type pipe filter



- JTGLL篮式过滤器，是一种较大型的管道过滤器，滤网的过滤面积是通径管道面积的2~3倍，适用于杂质含量最高，流量大的物料中。
- JTGLL篮式过滤器采用多道抛光处理，保证料液接触面Ra达到0.6 μm接近卫生级要求，全镜面抛光。
- JTGLL Basket Filter is a larger pipe filter. The area of mesh filtration is 2 ~ 3 times than the area of pipe diameter. It is suitable for the material with the highest content of impurities and the large amount of circulation.
- JTGLL Basket Filter using multiple polishing process ensures that the surface Ra reaching 0.6 μm up to the sanitary grade requirement, the filter surface is mirror polished.

产品特点

- 筒体内外表面采用镜面抛光，料液接触面Ra达到0.6 μm接近卫生级要求。
- 过滤器壳体可采用吊环螺栓连接或快装连接，操作方便，经济实用。

典型的应用

- 各种液体的颗粒过滤。
- 化工厂过滤。

Feature

- Inner and outside surface is all mirror polished ensuring that the material liquid contact surface Ra reaches 0.6 μm up to the sanitary grade requirement.
- Filter housing can use Eyebolt connection or quick-open connection, which is convenient for operation. Also it is a economical and practical design which is convenient for operation and economical and practical.

Application

- All kinds of particle filtration of liquid.
- Chemical filtration.



常规结构 Structure

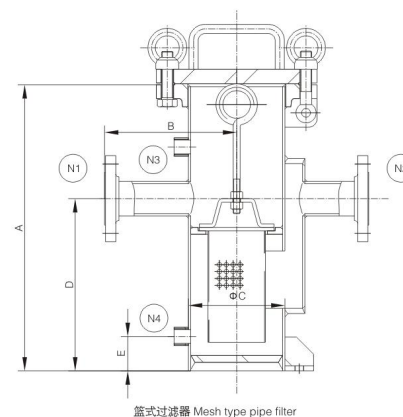

操作条件 Operating Conditions

最大操作压力 Max operating pressure	0.6MPa、1.0MPa
最大操作温度 Max operating temperature	140℃

材料 Material

过滤器壳体 Shell	304、316L、双相钢、钛材、哈氏合金
排气/液阀 Vent/ Drain valve	304、316L
吊环螺栓 Eyebolt	304
密封圈、垫片 O-ring	三元乙丙橡胶、聚四氟乙烯、氟橡胶、硅橡胶 EPDM, PTFE, Viton, Silicone

连接 Connection

壳体连接 Connection of shell	快装、法兰(吊环螺栓)Tri-clamp, Flange(Eyebolt)
进出口N1、N2 In-outlet	法兰快装螺纹 Flange, Tri-clamp, Thread
排气阀N3(选配) N3 Vent valve (option)	3/4"外螺纹 Male thread
排液阀N4(选配) N4 Drain valve(option)	1"外螺纹 Male thread

表面处理 Surface Finish

处理类型 Finish type	机械抛光、电解抛光、喷砂 Mechanical/electrolytical polishing, sand blasting
抛光精度 Polishing precision	内壁 0.6 μm Inner surface Ra≤0.6 μm 外壁 0.8 μm Outside surface Ra≤0.8 μm

尺寸参数表 Dimension Parameters

	1篮 L			
	进出口2" In-outlet 2"	进出口3" In-outlet 3"	进出口4" In-outlet 4"	进出口5" In-outlet 5"
A: 总高(不含滤盖) Total height	500	580	670	830
B: 进口中心距 The distance from inlet to center	230		260	300
C: 直径 Shell diameter	Φ 6"		Φ 10"	Φ 14"
D: 进出口N1、N2离地高度 N1, N2 The height from in-outlet to ground	300	360	430	560
E: 排液口N4离地高度 N4 The height from drain valve to ground	60			

上表数据为标准型篮式过滤器，仅供参考，可根据客户要求定制；未注长度单位为mm。
The above-mentioned data is the standard, it can customize according to customer's requirements.

JTGLL 选型表 Selection Table

[滤篮数量 Qty. of basket]	[滤篮型号 Model of basket]	[壳体材料 Shell Material]	[进出口连接 In-outlet connection]	[密封圈 O-ring]
1L	30	4	F	E
1L=1篮 Basket	20=进出口2"对应滤篮(In-outlet 2" filter basket size); Φ100×200	4=304	F=法兰 Flange	E=三元乙丙橡胶 EPDM
	30=进出口3"对应滤篮(In-outlet 3" filter basket size); Φ110×250	6=316L	K=快装 Tri-clamp	P=聚四氟乙烯 PTFE
	40=进出口4"对应滤篮(In-outlet 4" filter basket size); Φ140×300	D=双相钢 Duplex SS	L=螺纹 Screw thread	V=氟橡胶 Viton
	50=进出口5"对应滤篮(In-outlet 5" filter basket size); Φ180×400	T=钛材 Titanium		S=硅橡胶 Silicone
		H=哈氏合金 Hastelloy		

JTGLF
直立式过滤器
Basket Type Filter新型篮式过滤器
New basket type filter

- JTGLF直立式过滤器是一款除去液体中少量固体颗粒，可保护压缩机，泵，仪表和其它设备的正常工作的小型改良篮式过滤器。
- JTGLF直立式过滤器采用多道抛光处理，保证料液接触面Ra达到 $0.6\mu\text{m}$ 接近卫生级要求，全镜面抛光。
- JTGLF Basket Type Filter is a improved small basket strainer which can remove a small amount of solid particles in the liquid, also can protect compressor, pump, instruments and other equipment to work normally.
- JTGLF Basket Type Filter adopts multiple polishing processing steps to ensure that the interface Ra reaches to $0.6\mu\text{m}$ up to sanitary grade. All of the surface is mirror polished.

典型的应用

- 各种液体的颗粒过滤。
- 食用油、饮料、酒类的过滤。
- 化工厂过滤。
- 压缩机、泵、仪表和其它设备初过滤和保护作用。

Application

- All kinds of liquid particle filtering.
- Edible oil, beverage, wine filtration.
- Chemical filter.
- Compressors, pumps, instrumentation and other equipment pre-filtering and protection.



产品特点

- 筒体内外表采用镜面抛光，料液接触面Ra达到 $0.6\mu\text{m}$ 接近卫生级要求。
- 过滤器壳体可采用吊环螺栓连接或快装连接，操作方便，经济实用。
- 小规格过滤器在支脚底部安装调节螺母，可进行过滤器的高度调节，方便使用。

Feature

- The filter inner and outside surface using mirror polish, interface Ra reaching to $0.6\mu\text{m}$ close to sanitary level.
- Filter shell can use Eyebolt connection or quick-open connection, easy to Operating. Also it is a economical and practical design.
- Small size filters install adjusting screw nut at the bottom of the leg.



常规结构 Structure

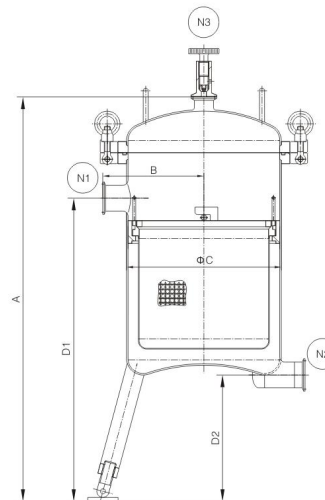

直立式过滤器 Basket Type Filter

操作条件 Operating Conditions

最大操作压力 Max operating pressure	0.6MPa、1.0MPa
最大操作温度 Max operating temperature	150°C

材料 Material

过滤器壳体 Shell	304、316L、双相钢、钛材、哈氏合金 304、316L、Duplex SS, Titanium, Hastelloy
排液阀 Vent valve	304、316L
吊环螺栓 Eyebolt	304
密封圈、垫片 O-ring	三元乙丙橡胶、聚四氟乙烯、 氟橡胶、硅橡胶 EPDM, PTFE, Viton, Silicone

连接 Connection

壳体连接 Connection of shell	法兰(吊环螺栓) Flange(Eyebolt)
进出口N1、N2 In-outlet	快装 Tri-clamp
排气阀N3(选配) N3 Vent valve (option)	1.5"快装 Tri-clamp

表面处理 Surface Finish

处理类型 Finish type	机械抛光、电解抛光、喷砂 Mechanical/electrolytical polishing, sand blasting
抛光精度 Polishing precision	内壁 $0.6\mu\text{m}$ Inner surface Ra $\leq 0.6\mu\text{m}$ 外壁 $0.8\mu\text{m}$ Outside surface Ra $\leq 0.8\mu\text{m}$

尺寸参数表 Dimension Parameters

	1篮 L		
	16型滤篮 16 Filter basket	25型滤篮 25 Filter basket	40型滤篮 40 Filter basket
A: 总高(不含压力表) Total height	800	1040	1170
B: 进口中心距 The distance from inlet to center	200	235	250
C: 直径 Shell diameter	Φ300	Φ350	Φ400
D1: 进口N1离地高度 The height from inlet to ground	600	800	900
D2: 出口N2离地高度 The height from outlet to ground	250	300	300
进出口N1、N2尺寸 In-outlet N1、N2 size	1.5"/2"/2.5"		

上表数据为标准型直立式过滤器，仅供参考，可根据客户要求定制；未注长度单位为mm。
The above-mentioned data is the standard, it can customize according to customer's requirements.

JTGLF 选型表 Selection Table

[滤篮型号 Model of basket]	[壳体材料 Shell Material]	[进出口连接 In-outlet connection]	[密封圈 O-ring]
25	4	K	E
16=过滤面积0.16m ² 的滤篮(filter area of filter basket is 0.16m ²); Φ256×254	4=304	F=法兰 Flange	E=三元乙丙橡胶 EPDM
25=过滤面积0.25m ² 的滤篮(filter area of filter basket is 0.25m ²); Φ312×375	6=316L	K=快装 Tri-clamp	P=聚四氟乙烯 PTFE
40=过滤面积0.40m ² 的滤篮(filter area of filter basket is 0.16m ²); Φ362×444	D=双相钢Duplex SS T=钛材 Titanium H=哈氏合金Hastelloy	L=螺纹 Screw thread	V=氟橡胶 Viton S=硅橡胶 Silicone

JTGTF
管式过滤器
Tube Filter高效管道式过滤器
Simple and efficient tube filter

- JTGTF管式过滤器是一款除去管道液体中少量固体颗粒，可保护压缩机、泵、仪表和其它设备的正常工作的小型改良高效管道式过滤器。
- JTGTF管式过滤器采用多道抛光处理，保证料液接触面Ra达到 $0.4\mu\text{m}$ 接近卫生级要求，全镜面抛光。
- JTGTF Tube Filter is a improved small tube strainer which can remove a small amount of solid particles in the liquid, also can protect compressor, pump, instruments and other equipment to work normally.
- JTGTF Tube Filter adopts multiple polishing processing steps to ensure that the interface Ra reach to $0.4\mu\text{m}$ close to sanitary level. All of the surface is mirror polished.

产品特点

- 筒体内外表面采用镜面抛光，料液接触面Ra达到 $0.4\mu\text{m}$ 接近卫生级要求。
- 过滤器壳体采用快装连接，操作方便，经济实用。

典型的应用

- 各种液体的颗粒过滤；
- 食用油、饮料、酒类的过滤；
- 化工厂过滤
- 压缩机、泵、仪表和其它设备初过滤和保护作用。

Feature

- The filter inner and outside surface using mirror polish, interface Ra reaching to $0.4\mu\text{m}$ up to sanitary level.
- Filter housing adopts quick connection, easy to handle, economical and practical.

Application

- All kinds of liquid particle filtering.
- Edible oil, beverage, wine filtration.
- Chemical filter.
- Compressors, pumps, instrumentation and other equipment pre-filtering and protection.

常规结构 Structure

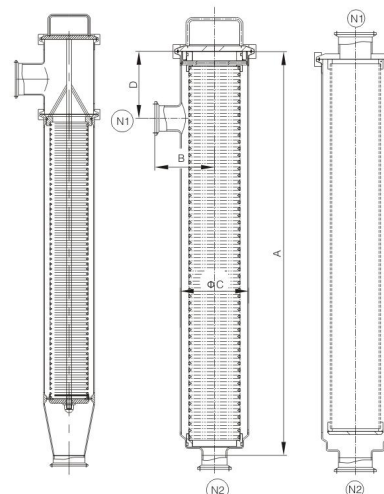

管式过滤器 Tube filter

操作条件 Operating Conditions

最大操作压力 Max operating pressure	0.6MPa、1.0MPa
最大操作温度 Max operating temperature	150°C

材料 Material

过滤器壳体 Shell	304、316L、双相钢、钛材、哈氏合金
筛管滤芯 Tube cartridge	304、316
密封圈、垫片 O-ring	三元乙丙橡胶、聚四氟乙烯、氟橡胶、硅橡胶 EPDM, PTFE, Viton, Silicone

连接 Connection

壳体连接 Connection of shell	快装 Tri-clamp
进出口N1、N2 In-outlet	2"/2.5"/3"快装 Tri-clamp

表面处理 Surface Finish

处理类型 Finish type	机械抛光、电解抛光、喷砂 Mechanical/electrolytical polishing, sand blasting
抛光精度 Polishing precision	内壁 $0.4\mu\text{m}$ Inner surface Ra $\leq 0.4\mu\text{m}$ 外壁 $0.6\mu\text{m}$ Outside surface Ra $\leq 0.6\mu\text{m}$

尺寸参数表 Dimension Parameters

	进出口2"				进出口2.5"				进出口3"	
	46滤芯 (Cartridge)	48滤芯 (Cartridge)	56滤芯 (Cartridge)	58滤芯 (Cartridge)	46滤芯 (Cartridge)	48滤芯 (Cartridge)	56滤芯 (Cartridge)	58滤芯 (Cartridge)	56滤芯 (Cartridge)	58滤芯 (Cartridge)
A: 总高(不含滤芯、压力表) Total height	621	833	621	833	621	833	621	833	621	833
B: 进口中心距 The distance from inlet to center	89				108				127	
C: 直径 Shell diameter	Φ101.6		Φ129		Φ101.6		Φ129		Φ129	
D: 进口N1离滤芯端面高度 InletN1 to filter cover height	100				100				100	
E: 筛管滤芯直径 The diameter of the filter screen	Φ76		Φ100		Φ76		Φ100		Φ100	
F: 筛管滤芯长度 The length of the filter screen	554	766	554	766	554	766	554	766	554	766

上表数据为标准型管式过滤器，仅供参考，可根据客户要求定制；未注长度单位为mm。
The above-mentioned data is the standard, it can customize according to customer's requirements.

JTGTF 选型表 Selection Table

[系列编号 Series number]	[滤芯数量 Qty. of cartridge]	[滤芯型号 Model of cartridge]	[壳体材料 Shell Material]	[进出口连接 In-outlet connection]	[进出口尺寸 Dimension]	[密封圈 O-ring]
A	1R	46	4	K	20	E
A=A系列 Series	1R=1芯1 Pcs	46	4=304	F=法兰 Flange	20=2"	E=三元乙丙橡胶 EPDM
B=B系列 Series	3R=3芯3 Pcs	48	6=316L	K=快装 Tri-clamp	25=2.5"	P=聚四氟乙烯 PTFE
C=C系列 Series	5R=5芯5 Pcs	56	D=双相钢 Duplex SS	L=螺纹 Screw thread	30=3"	V=氟橡胶 Viton
D=D系列 Series		58	T=钛材 Titanium			S=硅橡胶 Silicone
			H=哈氏合金 Hastelloy			

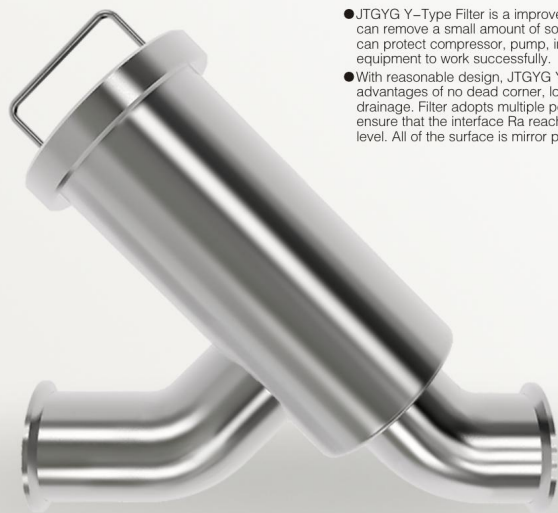
JTGYG
Y型过滤器
Y-Type Filter便捷更换管道式过滤器
Conveniently Replaceable
Tube Filter

- JTGYG Y型过滤器是一款除去管道液体中少量固体颗粒，通常安装在减压阀、泄压阀或其他设备的进口端，用来消除介质中的杂质，保护阀门及设备的正常使用。
- JTGYG Y型过滤器结构设计合理，无卫生死角，阻力小，排污方便等特点。采用多道抛光处理，保证料液接触面Ra达到 $0.4\mu\text{m}$ 接近卫生级要求，全镜面抛光。
- JTGYG Y-Type Filter is a improved small tube strainer which can remove a small amount of solid particles in the liquid, also can protect compressor, pump, instruments and other equipment to work successfully.
- With reasonable design, JTGYG Y-Type Filter achieves advantages of no dead corner, low resistance and easy drainage. Filter adopts multiple polishing processing steps to ensure that the interface Ra reach to $0.4\mu\text{m}$ close to sanitary level. All of the surface is mirror polished.

产品特色

- 筒体内外表面采用镜面抛光，料液接触面Ra达到 $0.4\mu\text{m}$ 接近卫生级要求。
- 过滤器壳体采用快装连接，操作方便，经济实用。

典型的应用

- 各种液体的颗粒过滤；
- 食用油、饮料、酒类的过滤；
- 化工厂过滤；
- 压缩机、泵、仪表和其它设备初过滤和保护作用。

Feature

- The filter inner and outside surface using mirror polish, interface Ra reaching to $0.4\mu\text{m}$ up to sanitary level.
- Filter housing adopts quick connection, easy to handle, economical and practical.

Application

- All kinds of liquid particle filtering.
- Edible oil, beverage, wine filtration.
- Chemical filter.
- Compressors, pumps, instrumentation and other equipment pre-filtering and protection.

常规结构 Structure

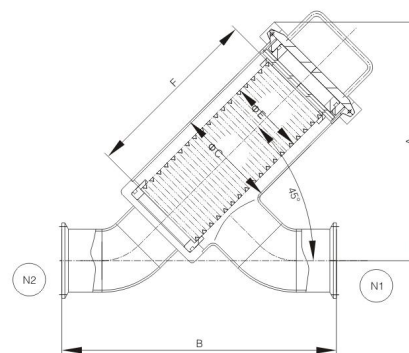

Y式过滤器 Y-Type Filter

操作条件 Operating Conditions

最大操作压力 Max operating pressure	0.6MPa、1.0MPa
最大操作温度 Max operating temperature	150°C

材料 Material

过滤器壳体 Shell	304、316L、双相钢、钛材、哈氏合金 304、316L、Duplex SS, Titanium, Hastelloy
筛管滤芯 Tube cartridge	304、316
密封圈、垫片 O-ring	三元乙丙橡胶、聚四氟乙烯、 氟橡胶、硅橡胶 EPDM, PTFE, Viton, Silicone

连接 Connection

壳体连接 Connection of shell	快装 Tri-clamp
进出口N1、N2 In-outlet	2"/2.5"/3"快装 Tri-clamp

表面处理 Surface Finish

处理类型 Finish type	机械抛光、电解抛光、喷砂 Mechanical/electrolytical polishing, sand blasting
抛光精度 Polishing precision	内圆 $0.4\mu\text{m}$ Inner surface Ra $\leq 0.4\mu\text{m}$ 外圆 $0.6\mu\text{m}$ Outside surface Ra $\leq 0.6\mu\text{m}$

尺寸参数表 Dimension Parameters

	进出口 In-outlet				
	1"	1.5"	2"	2.5"	3"
A: 总高(不含滤盖、压力表) Total height	185		240		300
B: 进口中心距 The distance from inlet to center	220		275		325
C: 直径 Shell diameter	$\Phi 76$		$\Phi 101.6$		$\Phi 129$
E: 筛管滤芯直径 The diameter of the filter screen	$\Phi 50$		$\Phi 76$		$\Phi 100$
F: 筛管滤芯长度 The length of the filter screen	135		180		225

上表数据为标准Y式过滤器，仅供参考，可根据客户要求定制；未注长度单位为mm。
The above-mentioned data is the standard, it can be customized according to customer's requirements. length: mm.

JTGYG 选型表 Selection Table

[滤芯数量 Qty. of cartridge]	[壳体材料 Shell Material]	[进出口连接 In-outlet connection]	[进出口尺寸 Dimension]	[密封圈 O-ring]
1R	4	K	20	E
1R=1芯1 Pcs	4= 304	F=法兰 Flange	10=1"	E=三元乙丙橡胶 EPDM
	6= 316L	K=快装 Tri-clamp	15=1.5"	P=聚四氟乙烯 PTFE
	D=双相钢 Duplex SS	L=螺纹 Screw thread	20=2"	V=氟橡胶 Viton
	T=钛材 Titanium		25=2.5"	S=硅橡胶 Silicone
	H=哈氏合金 Hastelloy		30=3"	

JTG CX 磁棒过滤器 Magnetic Fluid Filter

流体管道除铁器
Fluid pipe de-ironing separator

- JTG CX磁棒过滤器是一款应用于流体，半流体等不同粘性的流体物料中，去除铁杂质和其他铁磁性微粒，使物料保持清洁，同时又起到保护下游生产设备的作用。
- JTG CX磁棒过滤器采用多道抛光处理，保证料液接触面Ra达到 $0.6\mu\text{m}$ 接近卫生级要求，全镜面抛光。
- JTG CX Magnetic Fluid Filter is applied to the fluid, semifluid and other different viscous fluid materials, remove the iron impurities and other ferromagnetic particles. To keep the material clean and protect the downstream production equipment at the same time.
- JTG CX Magnetic Fluid Filter using multichannel polishing processing to ensure the interface Ra reach to $0.6\mu\text{m}$ close to sanitary level. All of the surface is mirror polished.

典型的应用

- 用于食品饮料、金属加工、制药、陶瓷、造纸、化妆品、精细化工等行业，保护关键设备免受铁质颗粒的破坏。

Application

- Used in food and beverage, metal processing, pharmaceutical, ceramics, paper, cosmetics, fine chemical industry, etc. To protect main equipment from the destruction of the iron particles.

产品特点

- 筒体内外表面采用镜面抛光，料液接触面Ra达到 $0.6\mu\text{m}$ 接近卫生级要求。
- 利用法兰，快装，螺栓板或者快速释放夹扣等设计，可以轻松安装，取出和清理磁性部件。
- 合理的结构设计，确保最好的除铁效果的同时不妨碍物料的流动。



Feature

- Barrel's internal and external surface using mirror polish, interface Ra reach to $0.6\mu\text{m}$ close to sanitary level.
- Using Flange, quick-open, eyebolt plate or quick release clamp can easy to install, take out and clean magnetic component.
- Reasonable structure design can ensure the best de-ferrous effect at the same time not impede the flow of the material.



常规结构 Structure



操作条件 Operating Conditions

最大操作压力 Max operating pressure	0.6MPa, 1.0MPa
最大操作温度 Max operating temperature	150°C

表面处理 Surface Finish

处理类型 Finish type	机械抛光、电解抛光、喷砂 Mechanical/electrolytic polishing, and blasting
抛光精度 Polishing precision	内壁 $0.6\mu\text{m}$ Inner surface Ra $\leq 0.6\mu\text{m}$ 外壁 $0.8\mu\text{m}$ Outside surface Ra $\leq 0.8\mu\text{m}$

材料 Material

过滤器壳体 Shell	304, 316L, 双相钢, 钛材, 哈氏合金 304, 316L, Duplex SS, Titanium, Hastelloy
密封圈、垫片 O-ring	三元乙丙橡胶、聚四氟乙烯、 氟橡胶、硅橡胶 EPDM, PTFE, Viton, Silicone

连接 Connection

壳体连接 Connection of shell	快装(0.6MPa)、法兰 (快速释放夹扣, 1.0MPa) Tri-clamp(0.6MPa), Flange (Quick release clamp, 1.0MPa)
进出口N1、N2 In-outlet	法兰/快装螺纹 Flange, Tri-clamp, Thread

尺寸参数表 Dimension Parameters

磁棒数 Qty. of magnet	筒体直径 Shell diameter	进出口N1、N2尺寸 Inlet and outlet N1、N2 size	磁棒 Magnetic bar	
			直径 Diameter	长度 Length
1	$\Phi 50$	1"/1.5"	$\Phi 20$	6"/8"/10"
4、5	$\Phi 114$	1"/1.5"/2"/2.5"		
6、7	$\Phi 159$	1.5"/2"/2.5"/3"		
9	$\Phi 190$	2"/2.5"/3"/4"		

进出口3"以下采用快装，3"和4"采用法兰，上表数据为标准型磁棒过滤器，仅供参考，可根据客户要求定制；未注长度单位为mm。
The diameter of In-outlet under 3" using quick-open, 3" and 4" using flange. It can customize according to customer's requirements. Dimension an approximate value, for reference only.

JTG CX 选型表 Selection Table

[系列编号 Series number]	[磁棒数量 No. of magnet]	[磁棒型号 Magnet model]	[壳体材料 Shell material]	[进出口连接 In-outlet connection]	[密封圈 O-ring]
A	9R	206	4	F	S
A=A系列 Series	1R=1芯 Pcs	206、208、210	4=304	F=法兰 Flange	E=三元乙丙橡胶 EPDM
B=B系列 Series	4R=4芯 Pcs/5芯 Pcs	例：206，其中2表示直径 $\Phi 20\text{mm}$ ，06表示长度6"的磁棒 Example: 206, "2" means diameter $\Phi 20\text{mm}$, "06" means magnetic bar the length of 6"	6=316L	K=快装 Tri-clamp	P=聚四氟乙烯 PTFE
C=C系列 Series	7R=6芯 Pcs/7芯 Pcs		D=双相钢 Duplex SS	L=螺纹 Screw thread	V=氟橡胶 Viton
D=D系列 Series	9R=9芯 Pcs		T=钛材 Titanium		S=硅橡胶 Silicone
E=E系列 Series			H=哈氏合金 Hastelloy		

JTGMF 机械过滤器 Mechanical Filter

大型水处理过滤器 Filter with pressure

- JTGMF机械(活性炭、多介质、锰砂)过滤器是一款是纯水制备前期预处理、水净化系统的重要组成部分,适用于要求经过过滤出水浊度一般在5毫克/升以内能符合饮用水水质标准的工业用水或生活用水的工矿企业和城镇给水处理设备。对工业污水中的悬浮物固体物等有很好的去除效果。水中含有的悬浮物凝聚的片状物用沉淀方法所不能去除的粘结胶质颗粒,可将水通过过滤器内所装的滤层,使水达到透明。
- JTGT管式过滤器采用多道抛光处理,保证料液接触面Ra达到 $0.4\mu\text{m}$ 接近卫生级要求,全镜面抛光。
- JTGMF Mechanical (Carbon, Sand) Filter Housing is an important part for Pure water preparation early pre-Finish and water purification system. It is apply to drinking water standard industrial water which is required filtered and general turbidity of treated water is within 5mg/L . It has good remove effect for suspended solids in industrial sewage. The Tablet agglomerated from suspended solids in water which can not remove through Precipitation method, we can through water to filter layer in filter vessel. Finally, to achieve transparency in water.
- JTGMF Mechanical Filter Housing using multichannel polishing processing to ensure the interface Ra reach to $0.6\mu\text{m}$ close to sanitary level. All of the surface is mirror polished.

产品特点

- 筒体内外表面采用镜面抛光,料液接触面Ra达到 $0.4\mu\text{m}$ 接近卫生级要求。
- 设备造价低廉,运行成本费用低,管理简便。
- 合理的结构设计,滤料经过反洗可多次使用,滤料寿命长,过滤效果好,占地面积小。

Feature

- Barrel's internal and external surface using mirror polish, interface Ra reach to $0.4\mu\text{m}$ close to sanitary level.
- The equipment low cost, low Operating cost and easy management.
- Reasonable structure design, after Filter material backwashing can use many times, filter material has long service life, effective filtering and small occupation area.

典型的应用

- 用于水处理过程中,主要用于给水处理除油,反渗透、以及离子交换软化除盐系统的前级预处理,也可用于地表水、地下水除泥沙。进水浊度要求小于20度,出水浊度可达3度以下。
- 可广泛应用于电子电力、石油化工、冶金电镀、造纸纺织、制药透析、食品饮料、生活饮用水、工厂企业用水、游泳池等。可满足各行业液体过滤需要。



Application

- It is used in water Finish, mainly used in turbidity removal, reverse osmosis and The front-end preprocessing of Ion exchange softening desalination system. It also can be used in remove sediment in Surface water and groundwater. The requirement of influent water turbidity should less than 20 degrees, and the turbidity of treated water can below 3 degrees.
- Can be widely used in Electronic power, oil chemical industry, metallurgy, electroplating, papermaking, textile, pharmaceutical dialysis, food and beverage, drinking water, Factories in water, swimming pool, etc. To meet the needs of the various industries liquid filtration.

常规结构 Structure

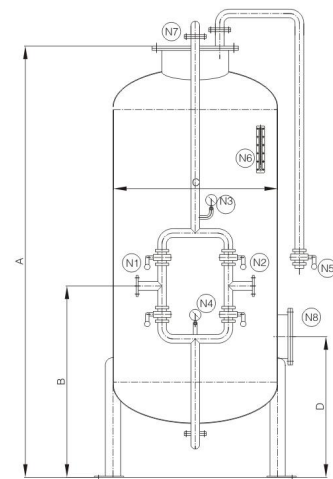

操作条件 Operating Conditions

最大操作压力 Max operating pressure	0.6MPa、1.0MPa
最大操作温度 Max operating temperature	120°C
壳体试压 The filter shell adopts	ATM(满水试压)(pressure test with full water)

材料 Material

过滤器壳体 Shell	304、316L、双相钢、钛材、哈氏合金 304, 316L, Duplex SS, Titanium, Hastelloy
支脚、吊具等 Stabilizer blade, sling	304
接管 Connect pipe	304
密封圈、垫片 O-ring	三元乙丙橡胶、聚四氟乙烯、 氟橡胶、硅橡胶 EPDM, PTFE, Viton, Silicone

连接 Connection

进出口N1、N2 In-outlet	1/2"法兰、快装、螺栓、Tri-clamp, Thread
压力表接口N3、N4 Pressure gauge connection	1.5"螺纹 Thread
排气阀接口N5 Vent valve connection	1/4"螺纹 Thread
视镜接口N6 Sight glass connection	法兰 Flange
人孔N7 Manhole	法兰 Flange
填料手孔N8 Packing hand hole	法兰 Flange

表面处理 Surface Finish

处理类型 Finish type	机械抛光、电解抛光、喷砂 Mechanical/electrolytical polishing, sand blasting
抛光精度 Polishing precision	内壁 $0.6\mu\text{m}$ Inner surface Ra $\leq 0.6\mu\text{m}$ 外壁 $0.8\mu\text{m}$ Outside surface Ra $\leq 0.8\mu\text{m}$

尺寸参数表 Dimension Parameters

	C: 壳体直径 Shell diameter										
	Φ600	Φ800	Φ1000	Φ1200	Φ1400	Φ1600	Φ1800	Φ2000	Φ2500	Φ3000	Φ3200
A: 总高 Total height	2350		2600		2800		2800		3000		
B: 进出口离地高度 The distance from inlet to center	1500				1800		1800		2000		
D: 填料手孔离地高度 The height from packing hand hole to ground	1200				1200		1200		1200		
设备出水流量 Equipment output(T/h)	1.4~2.8	2.5~5.0	4.0~8.0	5.5~11	7.5~15	10~20	13~25	16~30	25~49	35~70	40~80

上表数据为标准型机械(活性炭、多介质、锰砂)过滤器,仅供参考,可根据客户要求定制,未注长度单位为mm。
The above-mentioned data is the standard, it can customize according to customer's requirements.

JTGMF 选型表 Selection Table

[壳体直径 Shell diameter]			[壳体材料 Shell material]	[进出口连接 In-outlet connection]	[密封圈 O-ring]
600J			4	K	S
600J=直径Φ600机械过滤(下同) 600J=diameter Φ600 mechanical filtration			4=304	F=法兰 Flange	E=三元乙丙橡胶 EPDM
800J	1600J	3000J	6=316L	K=快装 Tri-clamp	P=聚四氟乙烯 PTFE
1000J	1800J	3200J	D=双相钢 Duplex SS	L=螺栓 Screw thread	V=氟橡胶 Viton
1200J	2000J		T=钛材 Titanium		S=硅橡胶 Silicone
1400J	2500J		H=哈氏合金 Hastelloy		

JTHXQ
呼吸器
Vent housing

- 卫生级呼吸器为制药、食品容器气体交换时达到除菌之目的而设计制造，能自动调节罐内压力，平衡罐内外压差。
- 滤筒采用不锈钢316L或304制作，内壁采用电解镜面抛光或机械抛光；内外光滑易清洗无死角。
- 聚四氟乙烯滤芯高效过滤细菌，保护罐内洁净无菌。
- The sanitary vent housing is designed and manufactured for the purpose of sterilization when exchanging gas for pharmaceutical and food containers. It can automatically regulate the pressure inside the tank and balance the pressure difference between the inside and outside of the container
- The filter is made of stainless steel 316L or 304, and the inner wall is polished by electrolytic mirror or mechanical polishing, easy to clean without dead corner
- PTFE filter cartridge filters bacteria efficiently and protects the tank clean and aseptic.

典型的应用

- 生物技术、精细化工、医药领域。
- 食品、饮料工业领域

Application

- Biological technology, fine chemical industry
- Medicine field. Food and beverage industry

产品特点

- 滤芯孔径均匀稳定、气体阻力小。
- 气体过滤精度为 $0.1\mu\text{m}$ ，效率达到99.99%，符合GMP无菌级要求。
- 接口采用快装卡盘式（卡接），罐体内胆选用304或316L，内表面镜面抛光 $Ra\leq 0.28\mu\text{m}\sim 0.6\mu\text{m}$ ，外表面可根据客户要求要求进行抛光等。

Feature

- The diameter of the filter core is uniform and stable with low gas resistance.
- The precision of gas filtration is $0.1\mu\text{m}$, reaching 99.99% efficiency reaches and meeting the requirements of GMP aseptic level.
- Interface with quick open type (clamp), tank with 304 or 316L, the inner surface of the mirror polishing $Ra\leq 0.28\mu\text{m}\sim 0.6\mu\text{m}$, the outer surface can be polished according to customers requirement



常规结构 Structure

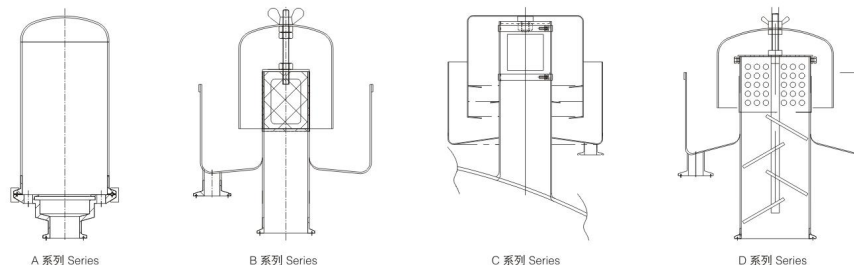

操作条件 Operating Conditions

最大操作压力 Max operation pressure	0.6MPa、1.0MPa
操作压力温度 Max operation temp.	150°C

材料 Material

滤筒 Housing	304、316L、双相钢、钛材、哈氏合金 304, 316L, Duplex SS, Titanium, Hastelloy
滤芯 Cartridge	PTFE、PP、丝网 Sintered screens
密封圈 O-ring	三元乙丙橡胶、聚四氟乙烯、硅橡胶 EPDM, PTFE, FKM Silicone

表面处理 Surface Finish

处理类型 Finish type	机械抛光、电解抛光 Mechanical/electrolytical polishing
抛光精度 Polishing precision	$0.4\mu\text{m}$

连接 Connection

壳体连接 Cup and bowl	快装 Clamp
进出口 Inlet and outlet	快装、法兰、活接 Clamp, Flange, Screw

尺寸参数表 Dimension Parameters

滤芯尺寸 Size	2.5"			5"			10"		
A: 直径 mm Diameter	76	89	102	76	89	102	76	89	102
B: 总高 mm Height	130			194			320		
C: 连接尺寸 mm Connection	50.5			50.5/64			64/77.5		

上表数据为标准型，仅供参考，可根据客户要求定制。

The above-mentioned data is the standard, for reference only. It can be customized according to customer's requirements

JTHXQ 选型表 Selection Table

系列编号 Serial No.	滤芯芯 Cartridge No.	壳体材料 Material	进出口连接 Connection	密封圈 O-ring
A	1R	4	K	E
A=A系列 A Serial	1R=1芯1 Pcs 1R=1round 1 Pcs	4=304 6=316L	F=法兰 Flange	E=三元乙丙橡胶EPDM
B=B系列 B Serial	2R	D=双相钢Duplex SS	K=快装 Clamp	P=聚四氟乙烯橡胶PTFE
C=C系列 C Serial	3R	T=钛材Titanium	L=螺纹 Screw	V=氟橡胶 FKM
D=D系列 D Serial		H=哈氏合金Hastelloy		S=硅橡胶 Silicon

JTGDB
大饼式过滤器
Lenticular Filter深层过滤器
Depth filter

- JTGDB大饼式过滤器是一种新型深层过滤器，可用于代替硅藻土过滤器，对各类液体中微小杂质进行过滤、澄清，提纯处理。
- 整体结构按照卫生级要求设计制造，料液无残留，极易清洗，高精度抛光；采用下进下出式结构设计，有效避免料液的紊流，提高过滤性能。
- JTGDB大饼式过滤器最多标配4个滤饼，能满足大流量的过滤要求。
- JTGDB Lenticular Filter is a new type of stacks filter, can be used in place of diatomite filter, for tiny impurities in varied kinds of liquid filtration, clarification, purification.
- The structure is designed and manufactured according to the health level, internal is no dead corner and mirror polishing, it ensure no residual liquid and easy to clean.
- JTGDB Lenticular Filter Housing can maximal install 4 filter stacks, it can fit for big flow requirements.

产品特点

- 下进下出的结构设计，方便清洗，在进出口可配置专门的排液阀，方便排液。
- 多饼过滤器时，可选择筒体多段开口的形式，方便更换滤饼，减少滤液渗出。

Feature

- Easy to clean, the inlet/outlet can be configured special discharge valve, easy to drain.
- Easy to replace the filter stacks, reduce the filter medium leakage.

典型的应用

- 酒类，糖浆，啤酒的微生物和固体过滤。
- 果汁和果汁浓缩灌装前的终端过滤。
- 果汁膜过滤之前的预过滤。
- 酒类，酶溶解，液体胶质，橄榄油的澄清过滤。
- 医药，化工，电子过滤。

Application

- Microbe and solid filtration of alcohol, syrup, beer.
- End filtration of fruit juice and juice concentrate.
- Pre filtering of juice membrane filtration.
- Clarification of alcohol, enzyme dissolution, liquid gum, olive oil.
- Pharmaceutical, chemical, electronic filtration.



常规结构 Structure

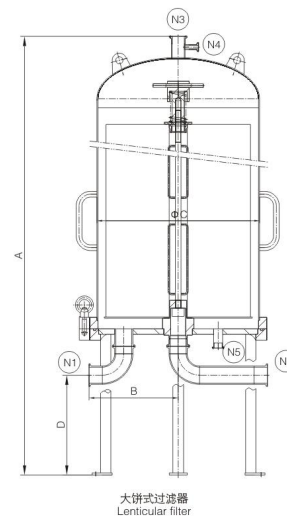

操作条件 Operating Conditions

最大操作压力 Max operating pressure	0.6MPa
最大操作温度 Max operating temperature	150°C
灭菌 Disinfect	在线或蒸汽灭菌：121°C/30min Online or steam sterilization: 121°C/30min

材料 Material

过滤器壳体 Shell	304, 316L, 双相钢, 钛材, 哈氏合金 304, 316L, Duplex SS, Titanium, Hastelloy
排气/液阀 Vent/ Drain valve	304, 316L
吊环螺栓 Eyebolt	304
支脚 Stabilizer blade	304
密封圈、垫片 O-ring	三元乙丙橡胶、聚四氟乙烯、 氟橡胶、硅橡胶 EPDM, PTFE, Viton, Silicone

连接 Connection

壳体连接 Connection of shell	法兰 Flange
进出口N1、N2 In-outlet	法兰快装螺栓 Flange, Tri-clamp, Thread
压力表N3(选配) N3 Pressure gauge (option)	1.5"快装 Tri-clamp
排液阀N4(选配) N4 Drain valve (option)	1"快装 Tri-clamp
排气阀N5(选配) N5 Vent valve (option)	1/2"快装 Tri-clamp

表面处理 Surface Finish

处理类型 Finish type	机械抛光、电解抛光 Mechanical/electrolytical polishing
抛光精度 Polishing precision	内壁 0.3 μm Inner surface Ra≤0.6 μm 外壁 0.4 μm Outside surface Ra≤0.8 μm

尺寸参数表 Dimension Parameters

	12"滤饼 Filter stacks				16"滤饼 Filter stacks			
	1滤饼 (B)	2滤饼 (B)	3滤饼 (B)	4滤饼 (B)	1滤饼 (B)	2滤饼 (B)	3滤饼 (B)	4滤饼 (B)
A: 总高(不含压力表) Total height	950	1210	1490	1760	960	1230	1500	1770
B: 进口中心距 The distance from inlet to center	200				250			
C: 直径 Shell diameter	Φ 325				Φ 450			
D: 进出口N1、N2离地高度 N1, N2 The height from in-outlet to ground	280				280			
进出口N1、N2尺寸 In-outlet N1, N2 size	2"				2"			

上表数据为标准型直立式过滤器，仅供参考，可根据客户要求定制；未注长度单位为mm。
The above-mentioned data is the standard, it can customize according to customer's requirements.

JTGDB 选型表 Selection Table

[滤饼数量 Qty. Of filter stacks]	[滤饼型号 Model of filter stacks]	[壳体材料 Shell material]	[进出口连接 In-outlet connection]	[密封圈 O-ring]
1B	12	4	F	E
1B=1饼 Pcs	12=12" 滤饼 Filter stacks	4=304	F=法兰 Flange	E=三元乙丙橡胶 EPDM
2B=2饼 Pcs	16=16" 滤饼 Filter stacks	6=316L	K=快装 Tri-clamp	P=聚四氟乙烯 PTFE
3B=3饼 Pcs		D=双相钢 Duplex SS	L=螺栓 Screw thread	V=氟橡胶 Viton
4B=4饼 Pcs		T=钛材 Titanium		S=硅橡胶 Silicone
		H=哈氏合金 Hastelloy		

JTGPY
圆盘式硅藻土过滤机
Disc-type Diatomite Filter新型硅藻土过滤器
New type diatomite filter

- JTGPY圆盘式硅藻土过滤机，对各类液体中微小杂质进行过滤、澄清，提纯处理其过滤元件是一张具有特殊结构的、间隙量恒定的金属细网，待过滤液体通过预涂硅藻土形成的过滤层，把待过滤液体中不需要的固相物质进行阻留，纯净的液体通过圆盘细网间的间隙汇集从空心中心管流出，达到液体的过滤。
- 整体结构按照卫生级要求设计制造，采用自动化的控制系统，高品质的水质滤化，过滤精度高、性能可靠、维护方便。
- JTGPY Disc-type Diatomite Filter for all kinds of tiny impurity in liquid filtration, clarification, purification process of the filter element is a special structure, interval stable metal mesh, when the liquid which need to be filtered pass by precoating diatomite filter layer, detention the unnecessary solid things in the liquid which need to be filtered, the pure liquid flow by the disc of the gap between mesh together from the hollow center pipe, achieve liquid filtration.
- The overall structure is designed and manufactured according to the sanitary standard, adopting automatic control system with high quality of water filtration, high filtration precision, reliable performance and easy maintenance.

典型的应用

- 酒类，糖浆，啤酒的微生物和固体过滤。
- 果汁和果汁浓缩灌装前的终端过滤。
- 果汁膜过滤之前的预过滤。
- 酒类，酶溶解，液体胶质，橄榄油的澄清过滤。
- 医药，化工，电子过滤。

Application

- Alcohol, syrup, beer, and solid filtration of microorganisms.
- End filtration of fruit juice and juice concentrate.
- Pre filtering of juice membrane filtration.
- Clarification of alcohol, enzyme dissolution, liquid gum, olive oil.
- Pharmaceutical, chemical, electronic filtration.

产品特点

- 过滤网精度高，根据工艺要求可达到20μm。
- 过滤圆盘加工制作精良，专用高精度焊接，设备焊接过滤网牢固、平整，耐压能力高。
- 传动简单、可靠。
- ① 采用电机——液力偶合。
- ② 减速机—联轴器，电机变频控制。
- 混合添加系统采用液压隔膜泵添加，适用物料范围广，运行可靠。
- 设备内部设有自动清洗功能，无需拆卸便可实现彻底清洗，自动化程度高。
- 配有残液过滤装置，滤液损失少。
- 结构紧凑、占地面积少、生产能力大。
- 根据用户要求，可实现啤酒、糖浆等全自动过滤。
- 根据需要，将硅藻土更换为PVPP，可实现PVPP过滤。

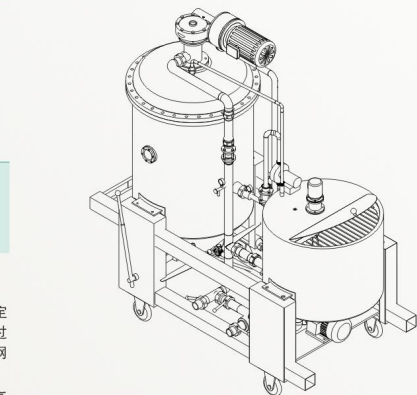

Feature

- High precision filtering, according to the technological requirements can be achieved 20μm.
- Well-made filtering disk processing, special and high precision welding, welding equipment filter is firm, smooth, high pressure resistance.
- Transmission is simple and reliable.
- ① Using the motor——hydraulic coupling.
- ② the reducer—coupling, motor frequency conversion control.
- Mix adding system adopts hydraulic diaphragm pump, wide applicable materials, reliable operation.
- Inside the equipment is equipped with automatic cleaning function, can achieve thoroughly clean without disassembly, high degree of automation.
- Equipped with residual liquid filtration unit, lose less filtrate.
- Compact structure, less land occupation, large production capacity.
- According to user requirements, beer, syrup and other automatic filtering can be realized.
- According to requirement, the diatomite can replace to PVPP, PVPP filtering can be realized.

常规结构 Structure

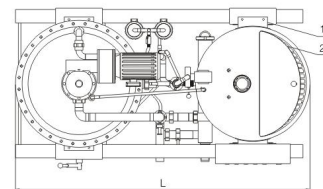
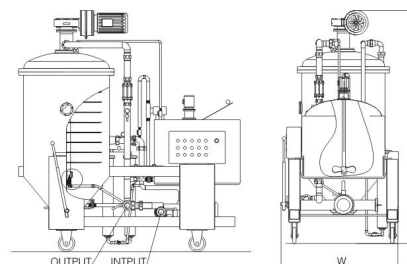

圆盘式硅藻土过滤机 Disc-type diatomite filter

操作条件 Operating Conditions

最大操作压力 Max operating pressure	0.6MPa
最大操作温度 Max operating temperature	85℃

材料 Material

过滤器壳体 Shell	304、316L、双相钢、钛材、哈氏合金 304、316L、Duplex SS, Titanium, Hastelloy
滤盘等 Filter disc etc	304、316L
滤液管、隔板等 Filtrate tube and plate etc	304
密封圈、垫片 O-ring	三元乙丙橡胶、聚四氟乙烯、 氟橡胶、硅橡胶 EPDM, PTFE, Viton, Silicone

连接 Connection

壳体连接 Shell connection	法兰 Flange
进口 Input	法兰/快装/螺纹 Flange, Tri-clamp, Thread
出口 Output	

表面处理 Surface Finish

处理类型 Finish type	机械抛光、电解抛光 Mechanical/electrolytical polishing
抛光精度 Polishing precision	内壁 0.4 μm Inner surface Ra≤0.6 μm 外壁 0.6 μm Outside surface Ra≤0.6 μm

尺寸参数表 Dimension Parameters

型号 Model	JTGPY12G700	JTGPY24G900
过滤面积 Filter area (m ²)	12	24
滤盘直径 Filter plate diameter (mm)	700	900
滤盘数量 Quantity	35	42
最大处理量 Max handle (m ³)	6	12
进出口尺寸 In-outlet dimension(Inch)	1.5"/2"/2.5"	2"/2.5"/3"
过滤电机 Filter motor (kw)	3	4
搅拌电机 Mixing motor (kw)	0.55	0.55
外形尺寸 Shell dimension(mm)	2300 × 1200 × 2500	2500 × 1400 × 2800

上表数据为标准型，可根据客户要求定制，未注长度单位为mm。
The above-mentioned data is the standard, it can customize according to customer's requirements.

JTGPY 选型表 Selection Table

[过滤面积 Diatomite filtration Filter area]	[滤盘直径 Filter plate diameter]	[壳体材料 Shell material]	[进出口连接 In-outlet connection]	[密封圈 O-ring]
12G	700	4	F	E
12G=12 m ² 硅藻土过滤	700=直径(Diameter)Φ700的滤盘	4= 304	F=法兰 Flange	E=三元乙丙橡胶 EPDM
24G=24 m ² 硅藻土过滤	900=直径(Diameter)Φ900的滤盘	6= 316L	K=快装 Tri-clamp	P=聚四氟乙烯 PTFE
		D=双相钢 Duplex SS	L=螺纹 Screw thread	V=氟橡胶 Viton
		T=钛材 Titanium		S=硅橡胶 Silicone
		H=哈氏合金 Hastelloy		

JTGKQ 空气(蒸汽)过滤器 Gas(Steam) Filter

气体除颗粒过滤器
Filter for removing particle in gas

- JTGKQ空气(蒸汽)过滤器是一款配合滤芯应用的高纯度气体除颗粒过滤器。
- 配合聚四氟乙烯高效除菌滤芯，可以应用在无菌的气体、发酵气体过滤；配合玻璃纤维滤芯，可以应用在一些高纯度气体过滤；配合不锈钢滤芯，可以解决高温气体过滤问题。
- 滤芯接头统一设计成226双密封圈卡口式，使得滤芯的密封性能更优秀。
- JTGKQ Gas(Steam) Filter Housing is a high purity particle filter using with filter cartridge for removing particle in gas.
- Using with PTFE efficient aseptic filter cartridge can be used in sterile gas and fermentation gas filtration. Using with glass fiber filter cartridge, can be used in high purity gas filtration. Using with stainless steel cartridge, can solve the problem of high Temp. air filtration.
- Filter connection unified designed to 226 double seal clamp type, to make the filter sealing performance is more outstanding.



产品特点

- 滤芯接头采用226双密封圈卡口式，确保密封。
- 3芯以下过滤器壳体可采用快装，更换滤芯时方便快捷。

典型的应用

- 在生物技术、医药领域的杀菌功能。
- 食品和饮料的杀菌，对加热食物的蒸汽进行过滤。
- 电子行业、生物技术、制药等实验室的湿气过滤。

Feature

- Filter connection adopts 226 double seal clamp type, to ensure the sealing.
- The cartridge number under 3 the filter housing can adopt quick-open, to be convenient and quick when change cartridge.

Application

- The sterilization function in the field of biotechnology, medical.
- Sterilizing for beverage and food, filtering steam for heating food.
- Filtering dampness in laboratory such as electronics industry, biotechnology, pharmaceutical etc.



常规结构 Structure

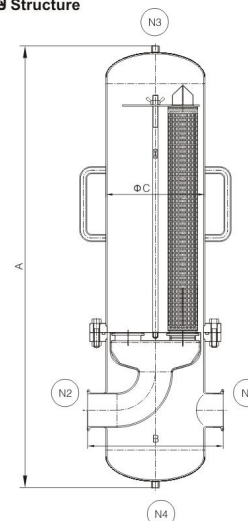

空气(蒸汽)过滤器(226型)
Gas(Steam) Filter Housing(226 Type)

操作条件 Operating Conditions

最大操作压力 Max operating pressure	0.6MPa、1.0MPa
最大操作温度 Max operating temperature	150℃
灭菌 Disinfect	在线或蒸汽灭菌: 121℃/30min Online or steam sterilization: 121℃/30min

材料 Material

过滤器壳体 Shell	304、316L、双相钢、钛材、哈氏合金 304、316L、Duplex SS, Titanium, Hastelloy
排液阀 Drain valve	304、316L
密封圈、垫片 O-ring	三元乙丙橡胶、聚四氟乙烯、 氟橡胶、硅橡胶 EPDM, PTFE, Viton, Silicone

连接 Connection

壳体连接 Connection of shell	法兰/快装 Flange, Tri-clamp
进出口N1、N2 In-outlet	法兰/快装螺纹 Flange, Tri-clamp, Thread
压力表N3(选配) N3 Pressure gauge (option)	M14×1.5(螺纹以下) M14×1.5 Thread(less than 3pcs) 1/2"螺纹(5芯以下) 1/2" Thread(less than 5pcs)
排液阀N4(选配) N4 Drain valve (option)	1/4"螺纹 Thread
滤芯接头形式 Cartridges connection	226型 Type

表面处理 Surface Finish

处理类型 Finish type	机械抛光、电解抛光 Mechanical/electrolytical polishing
抛光精度 Polishing precision	内壁 0.3 μm Inner surface Ra≤0.6 μm 外壁 0.4 μm Outside surface Ra≤0.8 μm

尺寸参数表 Dimension Parameters

	1芯 R				3芯 R				5芯 R				9芯 R			
	10"滤芯 Cartridge	20"滤芯 Cartridge	30"滤芯 Cartridge	40"滤芯 Cartridge	10"滤芯 Cartridge	20"滤芯 Cartridge	30"滤芯 Cartridge	40"滤芯 Cartridge	10"滤芯 Cartridge	20"滤芯 Cartridge	30"滤芯 Cartridge	40"滤芯 Cartridge	10"滤芯 Cartridge	20"滤芯 Cartridge	30"滤芯 Cartridge	40"滤芯 Cartridge
A: 总高(不含压力表) Total height	550	800	1050	1300	696	946	1196	1446	728	978	1228	1478	835	1085	1335	1585
B: 进出口距 The distance from inlet to center	150(快装)(Tri-clamp)				270(快装)(Tri-clamp)				270(快装)(Tri-clamp)				395(快装)(Tri-clamp)			
C: 直径 Shell diameter	Φ101.6				Φ200				Φ219				Φ325			
进出口N1、N2尺寸 In-outlet N1, N2 size	1"				3"				3"				4"			

上表数据为标准型空气(蒸汽)过滤器，仅供参考，可根据客户要求定制；未注长度单位为mm。
The above-mentioned data is the standard, it can customize according to customer's requirements.

JTGKQ 选型表 Selection Table

[滤芯数量 Qty. of cartridges]	[滤芯型号 Model of filter stacks]	[壳体材料 Shell material]	[进出口连接 In-outlet connection]	[密封圈 O-ring]
5R	20	4	K	E
1R=1芯 Pcs	10=10" 滤芯 Cartridge	4=304	F=法兰 Flange	E=三元乙丙橡胶 EPDM
3R=3芯 Pcs	20=20" 滤芯 Cartridge	6=316L	K=快装 Tri-clamp	P=聚四氟乙烯 PTFE
5R=5芯 Pcs	30=30" 滤芯 Cartridge	D=双相钢 Duplex SS	L=螺纹 Screw thread	V=氟橡胶 Viton
9R=9芯 Pcs	40=40" 滤芯 Cartridge	T=钛材 Titanium		S=硅橡胶 Silicone
12R=12芯 Pcs		H=哈氏合金 Hastelloy		

JT 双联(多联)过滤器 Duplex (Multi) Strainer

- 双联(多联)过滤器是一种由两台(多台)不锈钢过滤器并联而成, 可根据实际情况进行定制, 具有结构新颖合理、密封性好、流通能力强、操作简便等诸多优点, 应用范围广泛、适应性强的多用途过滤设备; 并可配套输送泵组装在移动式推车上, 以随意移动到任何生产线上进行过滤。
- 双联(多联)过滤器采用快装接口或法兰接口, 设计压力均达到 1.0MPa。

- Duplex (multi) Strainer is composed of two (more) stainless steel filters, can be customized according to the actual situation. It has many advantages, such as reasonable and novel structure, reliably sealing, good fluidity and easy and simple to handle etc. Also this Multipurpose filtering equipment has wide range of application and outstanding adaptation. Delivery pump can be assembled on the mobile cart, in order to move to any production line for filtering.
- Duplex (multi) Strainer adopts quick-open connection or flange connection, design pressure are reached to 1.0MPa.



JT 反渗透系统 Reverse Osmosis System

系统说明

反渗透(RO)是自然渗透的逆过程。如果在溶剂一侧加上一个大于渗透压的压力, 溶液中的溶剂就会从溶液一侧透过半透膜渗透到溶剂一侧, 这一现象即为反渗透。反渗透过程所使用的半透膜为反渗透膜。借助压力使水分子(小分子)强迫对水分子(小分子)有选择透过作用的反渗透膜, 既是反渗透工作原理。

System Description

Reverse Osmosis(RO) is an inverse process in natural permeability. If add a pressure greater than osmotic pressure at the side of solvent, solvent in the solution will through semipermeable membrane to other side of solvent, this phenomenon is named reverse osmosis. Semipermeable membrane used in reverse osmosis process is reverse osmosis membrane. With the help of the pressure of water (small molecules) force (small molecules) through reverse osmosis membrane is the Operating principle of reverse osmosis.

应用领域

- 电子、医药及各种工业纯水、超纯水制备。
- 海水淡化、苦咸水淡化、饮用水纯化。
- 各种水溶液的脱盐、分离及浓缩。
- 废水再利用。

Application Fields

- Electronics, medical and all kinds of industrial pure water, ultrapure water preparation.
- Seawater, brackish water desalination, drinking water purification.
- Desalination, separation and enrichment of various kinds of aqueous solution.
- Waste water reuse.

标准配置

一个反渗透系统由反渗透膜(RO膜)、增压装置、压力容器、保安过滤器、检测和测量仪表、控制阀门、管件、反冲洗、化学清洗等组成。

Standard Configuration

A reverse osmosis system is composed of reverse osmosis membrane, supercharging device, pressure vessel, security filters, testing and measuring instruments, control valves, pipe fittings, reverse flushing, chemical cleaning.

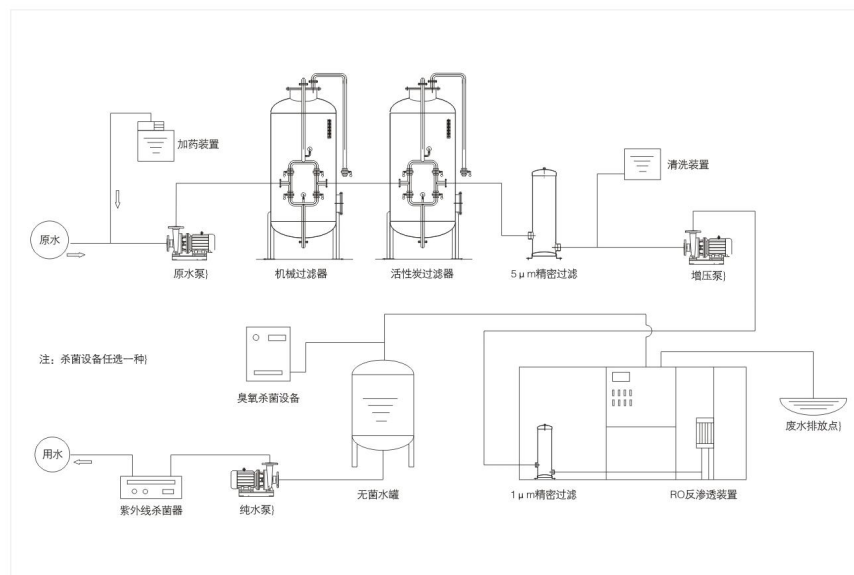

JT 葡萄酒过滤系统 Wine Filtration System

系统说明

- 通常安装在灌酒机之前，用以除去葡萄酒中的有害微生物和细小颗粒，以确保葡萄酒的生物稳定性和非生物稳定性。
- 传统的板框式纸板过滤器由于结构复杂，占地面积大、更换纸板繁杂、劳动强度大和高投资，目前在葡萄酒行业已不在选用。

过滤材质及精度

- 预过滤器
用于保护终过滤器(除菌过滤器)并延长其使用寿命，滤袋采用聚丙烯材质，高通量和增强的容污能力。过滤精度为 $1\mu\text{m} \sim 2\mu\text{m}$ 。
- 保护终过滤器(除菌过滤器)
用于除去葡萄酒中的有害微生物，保证酒体的微生物稳定性。滤芯采用尼龙66或聚醚砜膜式滤材，绝对过滤精度为 $0.45\mu\text{m}$ ，具有天然的亲水性，所用材料均符合FDA和GMP要求，具有耐高温，溶出物低和起始压差低，使用寿命长等特点。
- 水过滤器
水经过该过滤器后对预过滤器进行反向清洗，而对除菌过滤器进行正向清洗，用以提高过滤系统的使用寿命，过滤精度 $1\mu\text{m}$ ，聚丙烯或硼硅酸盐材质的折叠滤芯。

标准配置

一个标准配置的葡萄酒过滤系统由预过滤器、除菌过滤器以及相应的管件、阀门、压力表、泵等组成。系统采用316L或304不锈钢材质，亚弧焊接，内外表面镜面抛光，卫生级设计。

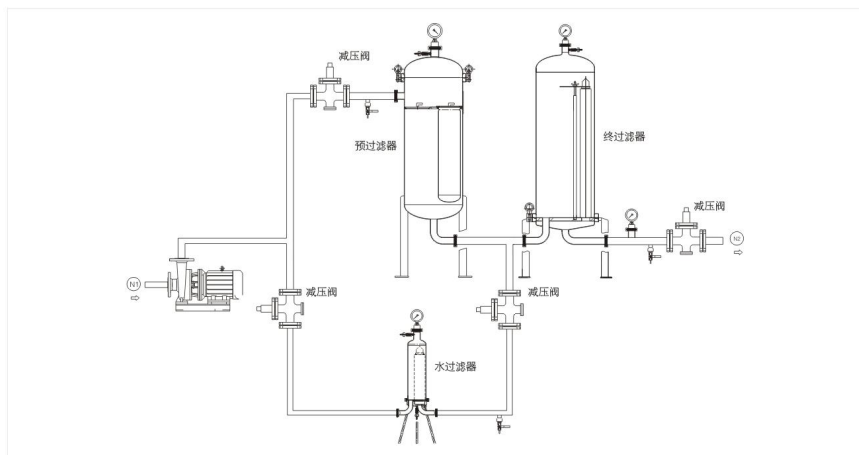

System Description

- Usually installed before drink machine, to remove the harmful microbes in wine and tiny particles, in order to ensure the biological stability and non-biological stability of the wine.
- Due to the traditional plate and frame type paper filter's complicated structure, large area occupied, troublesome paperboard replaced, high labor intensity and high investment. Nowadays, the wine industry no longer choose this kind of filter.

Filter Material and precision

- Pre-filter
Used to protect the end filter (aseptic filter) and extend its service life, the filter bag using polypropylene material, high throughput and enhanced accommodate dirt capacity. Filter precision $1\mu\text{m} \sim 2\mu\text{m}$. Used to protect the end filter (aseptic filter) and extend its service life.
- Protection terminal filter (aseptic filter)
Used to remove the harmful microbes in wine, to ensure microbiological stability of wine. The filter cartridge adopts nylon 66 or PES membrane filter material, filtering precision $0.45\mu\text{m}$, with natural hydrophilicity. All of material accord with FDA and GMP requirement, with features such as high Temp.resistance, low dissolved matter and low Initial Press pure Drop and long service life.
- Water filter
Start reverse cleaning the pre-filter after water through the filter, and begin to clean sterilizing filter for extend the service life of filter system. Filter Precision $1\mu\text{m}$, PP or borosilicate material pleated filter cartridge.

Standard Configuration

A standard configuration wine filtration system is composed of pre-filter, aseptic filters and the corresponding pipe fittings, valves, pressure gauge and pump. The system adopts stainless steel 316L or 304, argon arc welding, surface mirror polished, sanitary grade design.

JT 气体除菌过滤系统 Wine Filtration System

过滤芯材质及精度

- 预过滤器
绝对过滤精度为 $0.5\mu\text{m}$ (液体中的过滤精度为 $5\mu\text{m}$)，聚丙烯材质，折叠结构，大过滤面积，渐变孔径结构，226接口形式(卡入式)。主要目的是用于保护除菌过滤器滤芯。
- 终过滤器(除菌过滤器)
气体中绝对过滤精度 $0.01\mu\text{m}$ (液体中的过滤精度为 $0.2\mu\text{m}$)，聚四氟乙烯(聚四氟乙烯)或聚偏二氟乙烯膜式滤材，折叠结构，高通量，100%除菌效率，可在线蒸汽消毒。226接口形式(卡入式)。
- 蒸汽过滤器
绝对过滤精度 $3\mu\text{m}$ ，不锈钢烧结滤芯，可清洗后重复使用。

应用领域

- 啤酒/饮料
- 糖化冷麦汁充氧；
 - 发酵/清酒罐进气备压；
 - 酵母扩大培养通风；
 - 灌装用气备压；
- 发酵工业/生物制药
- 发酵罐进气及尾气除菌过滤；
 - 种子罐进气除菌过滤；
 - 高压消毒进气过滤；
 - 储存罐无菌室进气过滤；

标准配置

一个标准配置的气体除菌过滤系统由预过滤器、除菌过滤器、蒸汽过滤器以及相应的管件、阀门、压力表等组成。系统采用316L或304不锈钢材质，亚弧焊接，内外表面镜面抛光，卫生级设计。

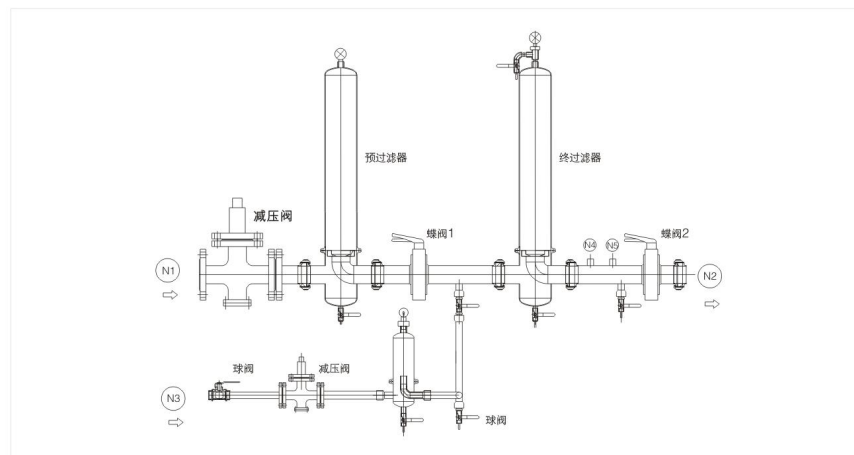

Filter Material and precision

- Pre-filter
Filtering precision is $0.5\mu\text{m}$ (filter precision of liquid is $5\mu\text{m}$). Polypropylene material, n folding structure, big filter area, gradually-varied pore diameter structure, 226 connection type(clamp). The main purpose is used to protect aseptic filter cartridge.
- Terminal filter (aseptic filter)
Filtering precision in air is $0.01\mu\text{m}$ (filter precision of liquid is $0.2\mu\text{m}$). PTFE or Polyvinylidene fluoride membrane filter material, folding structure, high throughput, 100% antibacterial efficiency, can sterilize with steam online. 226 connection type(clamp).
- Steam filter
Absolute filter filtration precision is $3\mu\text{m}$, stainless steel sintered filter, can be reused after cleaning.

Application Fields

- Beer/Beverage
- Cold saccharifying wort oxygenation
 - Fermentation/bright beer tank air inlet for press
 - Ventilate for extend yeast growing
 - Filling the gas pressure
- Fermentation/biopharmaceutical industry
- Fermentation tank inlet and exhaust aseptic filtration
 - Seeding tank inlet sterile Filtration
 - High pressure disinfection inlet filtration
 - Storage tanks sterile room inlet filtration

Standard Configuration

A standard configuration Gas aseptic filtration system is composed of pre-filter, aseptic filter, steam filter, and the corresponding pipe fittings, valves, pressure gauges, etc. The system adopts stainless steel 316L or 304, argon arc welding, surface mirror polished, sanitary grade design.

JT 无菌水设备过滤系统 Sterile Water Equipment Filtration Systems

过滤材质及精度

● 捕集过滤器

捕集过滤器，用于去除水中较大的颗粒杂质，采用Depth-Stack™ 深层膜堆滤饼，其过滤精度为 $10\mu\text{m} \sim 20\mu\text{m}$ 。

● 预过滤器

用于保护终过滤器(除菌过滤器)并延长其使用寿命，滤芯采用聚丙烯或硼硅酸盐材质，折叠结构，高通量和增强的容污能力。过滤精度为 $1\mu\text{m} \sim 2\mu\text{m}$ 。

● 终过滤器(除菌过滤器)

用于除去水中的有害微生物，保证工艺用水的微生物稳定性。滤芯采用尼龙66或聚醚砜膜式滤材，绝对过滤精度为 $0.2\mu\text{m}$ 或 $0.45\mu\text{m}$ ，具有天然的亲水性，所用材料均符合FDA和GMP要求，具有耐高温，溶出物低和起始压差低，使用寿命长等特点。

应用领域

食品/饮料行业

- CIP用水
- 物料调配用水
- 啤酒/饮料稀释用水
- 设备外部清洗用水
- 啤酒灌装发泡用水

发酵/制药行业

- 发酵罐流加用水
- 添加剂溶解用水
- 配料用水
- 矿泉水/饮用

Filter Material and precision

● Capture filters

Capture filters is used to remove larger particles impurities in water, adopt Depth-Stack™ lenticular filter cartridge, the filter precision is $10\mu\text{m} \sim 20\mu\text{m}$.

● Pre-filter

Used to protect the end filter (aseptic filter) and extend its service life, the material of cartridge adopts Polypropylene or boron silicate, folding structure, high flux. The filter precision is $1\mu\text{m} \sim 2\mu\text{m}$.

● Terminal filter (aseptic filter)

Used to remove the harmful microbes in the water, to ensure microbiological stability of the process water. Filter adopts nylon 66 or polyether sulfone membrane filter material, filtering precision is $0.2\mu\text{m}$ or $0.45\mu\text{m}$, with natural hydrophilic. The material comply with the FDA and GMP requirements, with high temp resistant low dissolution content and low initial press pure drop and long service life.

Application Fields

Food/beverage industries

- Water for CIP
- Water for material dispense
- Water for dilute beer/beverage
- Water for Clean the external equipment
- Water for Beer foam filling

Fermentation/pharmaceutical industry

- Water added to fermentation tank
- Water for dissolve additives
- Water for burdening
- Spring water/drinking water

Standard Configuration

A standard configuration sterile water filtration system is composed of capture filter, prefilter, aseptic filters and the corresponding pipe fittings, valves, pressure gauges, etc. The system adopts stainless steel 316L or 304, argon arc welding, surface mirror polished, sanitary grade design.

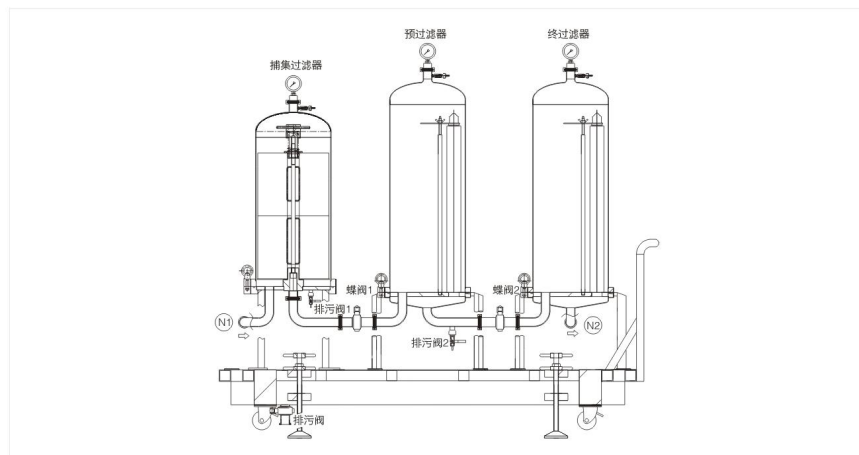

JT 过滤器参数表 The Filter Parameters Table

材质 Material

中国 China	中国台湾 China Taiwan	日本 Japan	美国 US	说明 State
GB	CNS	JIS	ASTM	
06Cr19Ni10	304	SUS304	304	良好的耐蚀性、耐热性、低温强度和机械特性；冲压、弯曲等热加工性好，无热处理硬化现象；无磁性，使用温度范围-196℃～800℃ Good corrosion resistance, heat resistance, low Temp. strength and mechanical features. Stamping, bending and other hot workability is good, without hardening phenomenon after heating. Nonmagnetic, Operating Temp. Range-196℃～800℃.
022Cr19Ni10	304L	SUS304L	304L	作为低碳的304不锈钢，在一般状态下，其耐蚀性与304不锈钢相似，但在焊接后或者消除应力后，其抗晶界腐蚀性能力优秀，在未进行热处理的情况下，亦能保持良好的耐蚀性，使用温度范围-196℃～800℃
06Cr17Ni12Mo2	316	SUS316	316	因添加Mo，故其耐蚀性、耐大气腐蚀性和高温强度特别好，可在苛刻的条件下使用；加工硬化性优，无磁性。 Because it is added Mo, its corrosion resistance, resistance to atmospheric corrosion resistance and high Temp. strength are especially good. Can be used at harsh conditions. Excellent work hardening, non-Magnetic.
022Cr17Ni12Mo2	316L	SUS316L	316L	作为低碳的316不锈钢，除与316不锈钢有相同的特性外，其抗晶界腐蚀性能力优秀。

粗糙度(抛光精度) Roughness(Polishing Precision)

目数(单位3 #) Mesh number (unit 3 #)	精度Ra(单位 μm) Precision Ra(unit μm)
400	0.2
300	0.3～0.4
200	0.6～0.8

镇田的标准 Standard of Jhenten

过滤器类型 Filter type	内壁 Inwall	外壁 Outer wall
卫生级 Sanitary	<0.3 μm	<0.4 μm
精密工业级 Precision industrial	<0.4 μm	<0.6 μm
普通工业级 Ordinary industrial	<0.6 μm	<0.8 μm

耐压和壁厚 Pressure And Wall Thickness

(仅限于直径 $\Phi 69$ ，226型/222型接头的标准滤芯)
(Limited to the diameter $\Phi 69$, 226/222 type standard filter connector)

壳体直径 Diameter	芯数 Qty. of cartridge	耐受力下壁厚(滤筒无腐蚀余量) Wall thickness under tolerance pressure (Non-corrosive allowance of cartridge)		
		0.6MPa	1.0MPa	1.6MPa
$\Phi 200$	3	2	2	2
$\Phi 219$	5	2	2.5	3
$\Phi 250$	5、6	2	2.5	4
$\Phi 273$	7	2.5	3	4
$\Phi 300$	8	2.5	3	4
$\Phi 325$	9、10	2.5	3	4
$\Phi 350$	11、12	2.5	3	4
$\Phi 400$	15、18	3	4	5
$\Phi 450$	21	3	4	5
$\Phi 500$	24、27、30	3	4	6

JT

过滤器参数表
The Filter Parameters Table

常用快装进出口尺寸
Common Dimension Of quick-open in-outlet

ISO:2852

公称尺寸 Nominal dimension	英寸 Inch	卡套外径 Chuck outer diameter	管子外径 Tube outer diameter
DN25	1	50.5	25.4
DN38	1.5	50.5	38.1
DN50	2	64	50.8
DN65	2.5	77.5	63.5
DN80	3	91.0	76.3
DN100	4	119.0	101.6

流量和管径的关系
The Relationship Between Flow Rate And Pipe Diameter

公称尺寸 Nominal dimension	英寸 Inch	液体估计流量 Liquid estimation flow (m³/h) (流速*πr²) (Flow rate*πr²)
DN15	1/2	1.3
DN20	3/4	2.3
DN25	1	3.0
DN38	1.5	9.0
DN50	2	14.1
DN65	2.5	23.9
DN80	3	36.2
DN100	4	56.5
DN125	5	88.4
DN150	6	127.2
DN200	8	226.2

常用滤袋参数表
Common Parameters Table Of Filter Bag

[滤芯类别 Cartridge category]	[型号及尺寸 Model and size] (mm)	[最大流量 Max flow rate] (m³/h)	[过滤面积 Filtering area] (m²/h)	[滤袋环口 Filter bag collar extension] 工艺：线缝	[过滤精度 Filter precision] (μm)
PP热熔滤袋 PP Hot melt filter bag	1号袋(Φ)：Φ180 x 430	20	0.25	不锈钢圈，代号S Stainless steel ring, Code: S	1、5、10、25、 50、75、100、150、 200、250、300
	2号袋(Φ)：Φ180x 810	40	0.5		
	3号袋(Φ)：Φ105 x 230	6	0.09	塑料圈，代号Q Plastic ring, Code: Q	
	4号袋(Φ)：Φ105x 380	12	0.16		
应用领域 Application fields	食品及饮料；生物工程及医药；石化及化工；汽车制造；石油及天然气；电子及电镀；涂料、油漆、油墨；核电与火电及废液过滤； 摄影胶片生产工艺液体过滤；日用化工的液体和气体净化；机械加工及制冷行业各种冷却液过滤；纺织、印染、造纸行业的各种液体净化。 Food and beverage; Biological project and medicine; Petrochemical and chemical industry; Automobile manufacturing; Oil and gas; Electroplating and electronics; Coating, paint, printing ink; Nuclear power and thermal power and waste liquid filtration; Process liquid filtration from film production; Daily chemical liquid and gas purification; Mechanical processing and refrigeration industry all kinds of coolant filtering; Textile, printing and dyeing, paper making industry of various liquid purification.				

常用法兰进出口尺寸
Common Dimension Of Flange In-outlet

HG/T 20592
B系列管子

公称尺寸 Nominal dimension	螺丝孔中心圆直径 Screw hole diameter in the center	法兰外径 Flange outer diameter	管子外径 Tube outer diameter
DN25	85	115	32
DN38	110	150	45
DN50	125	165	57
DN65	145	185	76
DN80	160	200	89
DN100	180	220	108
DN125	210	250	133
DN150	240	285	159
DN200	295	340	219

$Q=(\pi D^2)/4 \times V \times 3600$
Q：流量，流体在一定时间内通过某一横截面的容积或重量
D：管道内径(m)
V：流体平均速度(m/s)流体在管道内流动时，在一定时间内所流过的距离为流速常规液体估计值为2；空气估计值为10。
 $Q=(\pi D^2)/4 \times V \times 3600$
Q: Flow rate, The volume or weight of fluid flow in a certain period of time through a cross section.
D: Pipe Inner Diameter(m)
V: The average speed of fluid when fluid flow in the pipe, through the distance to the velocity of conventional liquid estimate is 2in a certain period of time. The air estimates is 10.

常用滤芯参数表
Common Parameters Table Of filter Cartridge

〔滤芯类别〕 Cartridge category〕	〔滤芯长度〕 Length of cartridge〕 (Inch)	〔滤芯直径〕 Cartridge diameter〕 (mm)	〔过滤精度〕 Filter precision〕 (μm)	过滤精度与流量关系 The relationship between flow rate and filter precision	〔应用领域〕 Application Fields〕	
PP微孔折叠滤芯 PP Microporous folded filter	10" 20" 30" 40"	Φ69	0.22, 0.45, 1, 3.5, 10, 20, 30, 50, 75, 100, 150, 200, 250, 300.	0.22(μm)=3(L/min) 0.45(μm)=3.3(L/min) 1(μm)=15(L/min) 3(μm)=20(L/min) 5(μm)=25(L/min) 10(μm)=30(L/min) 20(μm)=32(L/min) 30(μm)=36(L/min) 50(μm)=40(L/min) 70(μm)=45(L/min) 100(μm)=50(L/min) (备注：以上流量是按照10英寸长度的滤芯计算的) (Mark: The above flow is calculated according to the filter 10 inches in length)	医药行业：各种抗菌素等药液的前置过滤； 食品饮料业：酒类、矿泉水、饮用水的过滤； 石油工业：油田注水过滤； 电子工业：高纯水前置过滤； 化学工业：各种有机溶剂、酸、碱液的过滤； Pharmaceuticals industry: all kinds of antibiotics and other liquid prefiltering Food and beverage industry: wine, mineral water, drinking water filtration Electronic industry: high pure water prefiltering Chemical industry: filtering All kinds of organic solvents, acid, alkali	
PP熔喷滤芯 PP Meltblown Filter		Φ63			用于民生生活饮用水过滤R.O逆渗透过滤； 用于工业化学制程中酸碱液体之过滤； 工业用水、电镀液之过滤； 显像用药液、墨水之过滤； 无菌水、超纯水之前置过滤处理； 化工原料、有机溶剂之过滤； For people's livelihood drinking water filter R.O reverse osmosis filtration Filtration of the acid and alkali liquid in industrial chemistry process Industrial water, electric plating solution filtration Sterile water, ultrapure water front filtering processing Chemical raw materials, organic solvent filtration	
不锈钢折叠式滤芯 Stainless steel folding filter	10" 20" 30" 40"	Φ65	0.45、1、5、10、20、30、50	按照10英寸长度的钛棒滤芯的过滤精度 (0.1μm~30μm)时，流量0.25m³/h左右。	用于高分子聚合物及油水处理，高温气体，药品等介质的过滤。 Used for polymer and oil/water Finish, high Temp. gas, drugs such as medium filter.	
不锈钢烧结网滤芯 Stainless steel sintered network filter		Φ63, Φ65			用于聚酯、水处理，油品，制药，食品饮料，化工，化纤产品的过滤以及高温空气等介质的过滤。 Used for polyester, water Finish, oil, pharmaceutical, food and beverage, chemical industry, chemical fiber products, such as filter and high Temp.air medium filtering.	
钛棒烧结滤芯 Titanium rods sintered filter	10" 20" 30" 40"	Φ60			电子工业：电子、微电子、半导体工业用水等过滤； 医药工业：原料药、溶剂性药液、物料的脱碳过滤等过滤； 化学工业：有机溶剂、化学试剂、液体原料、催化剂等过滤； 食品工业：啤酒、饮料、矿泉水、植物油、酱油、醋等过滤； 炼油工业：油田回流水过滤、海水淡化领域反渗透前的保安过滤。 Electronic industry: electronic, microelectronics, semiconductor industrial water filter, etc. Pharmaceutical industry: active pharmaceutical ingredients, such as solvent solution, decarburization filtration of material filtering. Chemical industry: organic solvent, chemical reagents, liquid materials, catalyst filtering. The food industry, beer, beverage, mineral water, vegeTable oil, soy sauce, vinegar, filter, etc.	

上表仅供参考，可根据需要提供定制；过滤精度分绝对精度和相对精度，可供选择。
Above is for reference only, can according to the need to customized; Filtration precision points absolute accuracy and relative accuracy, and to choose from.

PP/PE/NMO 液体滤袋 Liquid Filter Bag

产品特点

- 聚丙烯(PP)/聚酯(PE)滤袋：多层折叠式复合深层过滤结构使其拥有更高的容污能力和更大的过滤流量；大表面积和密度递变深层过滤构造使其具有较长的使用寿命和高效的过滤能力；压差低，使用寿命较长；采用卫生级材质制造，过滤精度高，吸油功能出色；广泛的化学兼容性，适用于多种过滤环境。
- 尼龙(NMO)滤袋：尼龙单丝焊接，产品不易变形，抗拉伸强度高；网状结构固定孔径，定值过滤，稳定性好；加强外衬封边使密封圈结构更加稳定；适用于高粘度物料和硬性颗粒杂质过滤；精度较低的粗滤场合。

Feature

- Polypropylene (PP) / Polyester (PE) Liquid Filter Bag: Fold able multi-layer composite deep bed filtration structure make it has higher tolerance ability of sewage and the greater the filtration flow, long service life and efficient filtering capabilities are awarded to its large surface area and deep filtration structure of density progressive Change. Low differential pressure, long service life, the sanitary material manufacturing, high filtration precision, excellent oil absorption function, broad chemical compatibility for in a variety of filtering environment.
- Nylon (NMO) Liquid Filter Bag: nylon monofilament welding, not easy to deformation, high tensile strength; fixed aperture of mesh structure, fixed value filtering, excellent stability; more stable sealing ring structure due to strengthened outer lining sealing; suitable for filtration of high viscosity materials and hard particles and other coarse filtration.



典型的应用

- 聚丙烯(PP)/聚酯(PE)滤袋：应用于医药、食品饮料、精细化工、电子等行业以及工业上的甲醇、生物燃料生产、水处理与过滤。
- 尼龙(NMO)滤袋：应用于食品饮料、维生素提纯剂、啤酒中的助滤及滤清、回收昂贵的活性原料、高级UV涂料、粘性高的涂料、线路板用树脂、高级润滑油、凝胶胶体的滤液等。

Application

- Polypropylene (PP) / Polyester (PE) Liquid Filter Bag: applying in pharmaceuticals, food and beverage, fine chemical, electronics and methanol, bio fuel production, water treatment and filtration.
- Nylon (NMO) Liquid Filter Bag: applying in food and beverage, vitamin provided chain agent, beer assist-filtration and filtration and active ingredient recycling, UV coating, painting of high viscosity, a circuit board with resin, high grade lubricating oil, gel leachate.



技术参数 Technical Parameter

- 滤袋参数：
1号袋 (1S) : $\Phi 180 \times 430$; 2号袋 (2S) : $\Phi 180 \times 810$; 3号袋 (3S) : $\Phi 105 \times 230$; 4号袋 (4S) : $\Phi 105 \times 380$
- 部件材质：
袋身：聚丙烯 (PP)、聚酯 (PE)、尼龙 (NMO) 密封环口：塑料圈 (Q)、不锈钢圈 (S)
- 滤袋性能：
过滤精度：
聚丙烯 (PP) / 聚酯 (PE) 滤袋：1 μm , 5 μm , 10 μm , 25 μm , 50 μm , 75 μm , 100 μm , 150 μm , 200 μm , 250 μm , 300 μm
尼龙 (NMO) 滤袋：20 μm , 40 μm , 60 μm , 80 μm , 100 μm , 120 μm , 150 μm , 200 μm , 250 μm , 300 μm , 400 μm , 500 μm
有效过滤面积：
0.25 m^2 (1号袋) ; 0.50 m^2 (2号袋) ; 0.08 m^2 (3号袋) ; 0.15 m^2 (4号袋)
理论最大过滤水流量：
20 m^3/h (1号袋) ; 40 m^3/h (2号袋) ; 6 m^3/h (3号袋) ; 12 m^3/h (4号袋)
更换压差：
1.03kg/cm² ~ 1.72kg/cm² 聚丙烯 (PP) / 聚酯 (PE)、1.03kg/cm² ~ 2.41kg/cm² 尼龙 (NMO)
最高操作温度：
94°C 聚丙烯 (PP)、135°C 聚酯 (PE) / 尼龙 (NMO)
- Type & Size:
#1 (1S) : $\Phi 180 \times 430$; #2 (2S) : $\Phi 180 \times 810$; #3 (3S) : $\Phi 105 \times 230$; #4 (4S) : $\Phi 105 \times 380$
- Component Material:
Body: PP, PE, NMO Sealing Ring: plastic ring (Q), stainless steel ring (S)
- Performance Of The Liquid Filter Bag:
Precision:
PP/PE Liquid Filter Bag: 1 μm , 5 μm , 10 μm , 25 μm , 50 μm , 75 μm , 100 μm , 150 μm , 200 μm , 250 μm , 300 μm
NMO Liquid Filter Bag: 20 μm , 40 μm , 60 μm , 80 μm , 100 μm , 120 μm , 150 μm , 200 μm , 250 μm , 300 μm , 400 μm , 500 μm
Effective Filtration Area: 0.25 m^2 (#1); 0.50 m^2 (#2); 0.08 m^2 (#3); 0.15 m^2 (#4)
Maximum Filter Water Flow: 20 m^3/h (#1); 40 m^3/h (#2); 6 m^3/h (#3); 12 m^3/h (#4)
Pressure Difference To Change: 1.03kg/cm² ~ 1.72kg/cm²(PP)/(PE), 1.03kg/cm² ~ 2.41kg/cm²(NMO)
Maximum Operating Temperature: 94°C(PP), 135°C(PE)/(NMO)

选型表 Selection Table

JTLDPP	过滤精度 Precision		滤袋型号 Type	袋身工艺 Technique	密封环口 Sealing ring	袋底形状 Bottom shape
	10		1S	R	Q	H
JTLDPP聚丙烯滤袋		75=75 μm	1S=1号袋(#1); $\Phi 180 \times 430$	R=热熔 R=hot melt	Q=线缝塑料圈 Q=seamed plastic ring	H=线缝圆弧底 H=seamed arc bottom
JTLDPE聚酯滤袋	1=1 μm	100=100 μm	2S=2号袋(#2); $\Phi 180 \times 810$	F=线缝 F=Seam	S=线缝不锈钢圈 S=seamed stainless ring	V=焊接V型底 V=Welded V type bottom
JTLDNMO尼龙滤袋	5=5 μm	150=150 μm	3S=3号袋(#3); $\Phi 105 \times 230$			U=焊接U型底 U=Welded U type bottom
	10=10 μm	200=200 μm	4S=4号袋(#4); $\Phi 105 \times 380$			
	25=25 μm	250=250 μm				
	50=50 μm	300=300 μm				

聚丙烯(PP)微孔膜折叠滤芯 PP Microporous Membrane Folding Filter Cartridge

产品特点

- 杰出的化学兼容性，适合过滤强酸、强碱及有机溶剂；
- 滤膜为折叠式深层过滤，膜过滤面积大；
- 压差低，纳污能力强，使用寿命长；
- 有多种过滤精度可选择；
- 渐进式孔径变化提供超高纳污能力；
- FDA认证材料。

Feature

- Excellent chemical compatibility, suitable for the filtration of acid, alkali and organic solvent.
- Folding membrane with deep filtration, large filtering area.
- low pressure difference, excellent assimilative capacity, long service life.
- A variety of filtering precision can be selected.
- The gradual change of aperture to provide ultra high pollutant carrying capacity.

典型的应用

- 用于民生活饮用水过滤R.O反渗透过滤；
- 用于工业化学制程中酸碱液体之过滤；
- 工业用水、电镀液之过滤；
- 无菌水、超纯水之前置过滤处理；
- 化工原料、有机溶剂之过滤。

Application

- Drinking water filtration R.O reverse osmosis filtration.
- Filtration of acid and alkali liquids for industrial chemical process.
- Industrial water and plating solution filtration.
- Aseptic water, pre filtration treatment of ultra pure water.
- Filtration of chemical raw materials, organic solvent.

JTLXPP 选型表 Selection Table

过滤精度 Precision		滤芯长度 Length	滤芯接头 Cartridges connection	密封材质 Sealing Material	中心杆材质 Central Rod
10		10	S	E	S
0.1=0.1 μm	5=5 μm	10=10'	D=DOE型(双开) D=DOE type	E=三元乙丙橡胶 E=EPDM	S=不锈钢 S=SS
0.22=0.22 μm	10=10 μm	20=20'	T=222型(平尾) T=222 type	P=聚四氟乙烯 P=PTFE	B=聚丙烯 B=PP
0.45=0.45 μm	20=20 μm	30=30'	S=226型(翅片) S=226 type	V=氟橡胶 V=FKM	
1=1 μm	50=50 μm	40=40'		S=硅橡胶 S=Silicon	
3=3 μm					

技术参数 Technical Parameter

- 滤芯参数：
外径：Φ69mm 长度：10'，20'，30'，40'
滤芯接头：DOE型（双开）、222型（平尾）、226型（翅片）

- 部件材质：
滤材：聚丙烯（PP）
支撑/导流层，外壳/中心杆/端盖：聚丙烯
密封圈材质：三元乙丙橡胶，聚四氟乙烯，硅橡胶，氟橡胶

- 滤芯性能：
过滤精度：0.1 μm，0.22 μm，0.45 μm，1 μm，3 μm，5 μm，10 μm，20 μm，50 μm
有效过滤面积：≥0.65m²（10' 滤芯）
最高操作温度：1Bar 80℃，当温度超过50℃时，推荐更换内部支撑圈
压差：（最大压差）4.0Bar /25℃；（最大反压差）2.0Bar /25℃
消毒：121℃ /30min

- Type & Size:
Outer Diameter: 69mm Length: 10', 20', 30', 40'
Cartridges Connection: DOE type, 222 type, 226 type

- Component Material:
Body: PP
Supporting / Sublayer, Shell / Central / End Cap: Pp
Sealing Ring: EPDM, PTFE, FKM, Silicon

- Performance:
Precision: 0.1 μm, 0.22 μm, 0.45 μm, 1 μm, 3 μm, 5 μm, 10 μm, 20 μm, 50 μm
Effective Filtration Area: 0.65m² (Length: 10')
Max Operating Temperature: 1Bar 80℃, When the temperature exceeds 50 degrees, please replace the inner supporting ring.
Pressure Difference: (max pressure difference) 4.0Bar /25℃, (max back pressure difference) 2.0Bar /25℃
Disinfection: 121℃/30min

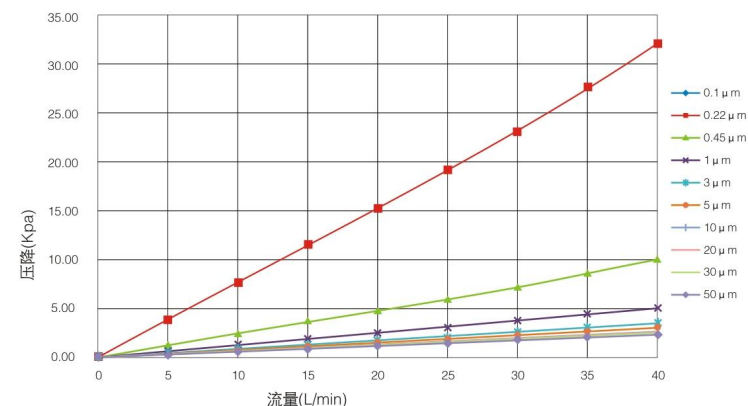

聚醚砜(PES)微孔膜折叠滤芯 PES Microporous Membrane Folding Filter Cartridge

产品特点

- 具有良好的耐高温，耐碱性；
- 滤膜亲水性好，通量大；
- 无介质脱落，符合医药，食品工业要求；
- 每支滤芯经完整性检测仪检测，且经高纯水冲洗。

Feature

- High-temperature tolerance, acid and alkali resistance.
- Good hydrophilicity and flux.
- No dielectric loss, in line with the requirements of the pharmaceutical, food industry.
- Each filter element is detected by the integrity tester and washed by high purity water.

典型的应用

- 医药和生物制品终端过滤；
- 饮用水、饮料、超纯水、酒类等终端过滤；
- 化学原料过滤。

Application

- Terminal filtration of pharmaceutical and biological products;
- Terminal filtration of drinking water, beverages, ultra pure water, alcohol ;
- Terminal filtration of chemical raw materials.



JTLXPES 选型表 Selection Table

过滤精度 Precision	滤芯长度 Length	滤芯接头 Cartridges connection	密封材质 Sealing Material	中心杆材质 Central Rod
10	10	S	E	S
0.05=0.05 μm	10=10'	D=DOE型(双开) D=DOE	E=三元乙丙橡胶 E= EPDM	S=不锈钢 S=SS
0.1=0.1 μm	20=20'	T=222型(平尾) T=222	P=聚四氟乙烯 P=PTFE	B=聚丙烯 B=PP
0.22=0.22 μm	30=30'	S=226型(翅片) S=226	V=氟橡胶 V=FKM	
0.45=0.45 μm	40=40'		S=硅橡胶 S=silicon	
0.65=0.65 μm				
1.2=1.2 μm				

技术参数 Technical Parameter

- 滤芯参数:
外径: Φ69mm 长度: 10', 20', 30', 40'
滤芯接头: DOE型(双开)、222型(平尾)、226型(翅片)
- 部件材质:
滤材: 聚醚砜(PES)
支撑/导流层, 外壳/中心杆/端盖: 聚丙烯
密封圈材质: 三元乙丙橡胶, 聚四氟乙烯, 硅橡胶, 氟橡胶
- 滤芯性能:
过滤精度: 0.05 μm, 0.1 μm, 0.22 μm, 0.45 μm, 0.65 μm, 1.2 μm
最高操作温度: 2Bar 80°C
压差: (最大压差) 4.0Bar /25°C; (最大反压差) 2.0Bar /25°C
消毒: 121°C/30min



- Type & Size:
Outer Diameter: Φ69mm Length: 10', 20', 30', 40'
Cartridges Connection: DOE type, 222 type, 226 type
- Component Material:
Body: PES
Supporting / Sublayer, Shell / Central / End Cap: Pp
Sealing Ring: EPDM, PTFE, FKM, Silicon
- Performance:
Precision: 0.05 μm, 0.1 μm, 0.22 μm, 0.45 μm, 0.65 μm, 1.2 μm
Max Operating Temperature: 2Bar 80°C
Pressure Difference: (max pressure difference)4.0Bar /25°C; (max back pressure difference)2.0Bar /25°C
Disinfection: 121°C/30min

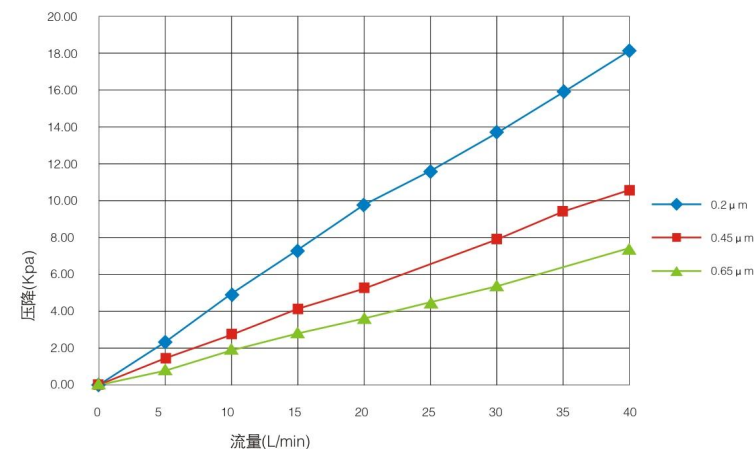

不锈钢烧结/折叠滤芯(熔体滤芯) Stainless Steel Sintered / Solding Silter Cartridge (Melt Filter Cartridge)

产品特点

- 全不锈钢结构，化学相容性广；
- 滤芯成折叠状后，过滤面积大，纳污量大；
- 滤芯耐高温、耐腐蚀、适用于高粘稠液体过滤；
- 再生性能好，经化学清洗、高温及超声清洗可反复使用；
- 滤芯空隙率高、透气性好、阻力小、使用压差低。

Feature

- Stainless steel structure, wide chemical compatibility.
- After the filter element is folded, the filter area is large, and the amount of the filter element is large.
- High temperature resistance, corrosion resistance, suitable for high viscous liquid filtration.
- Good regeneration performance, can be used repeatedly after the chemical cleaning, high temperature and ultrasonic cleaning.
- High void ratio, good air permeability, low resistance and low pressure difference.

典型的应用

- 用于高分子聚合物及药品、液压油、水处理、高温气体等介质过滤；
- 工艺用水和各种工艺流体，电镀液，金属蚀刻溶液，涂料光致抗蚀剂，去离子水预过滤等；瓶装水，各种酒类，糖浆，香料、食用油等过滤；酸、碱、溶剂、液体催化剂等各种化学品，凝结水、冷却水等。

技术参数

- 滤芯参数：
外径：Φ65mm 长度：10"，20"，30"，40"
滤芯接头：M20、M30、222型(平尾)、226型(翅片)
- 部件材质：
滤材：304、316L
密封圈材质：三元乙丙橡胶，聚四氟乙烯，硅橡胶，氟橡胶
- 滤芯性能：
过滤精度：0.5 μm，1 μm，3 μm，5 μm，10 μm，20 μm，50 μm

JTLXGZ 选型表 Selection Table

过滤精度 Precision		滤芯长度 Length	滤芯接头 Cartridges connection	密封材质 Sealing Material
1		10	M2	E
0.5=0.5 μm	10=10 μm	10=10"	M2=M20(螺纹) M2=M20 type	E=三元乙丙橡胶 E= EPDM
1=1 μm	20=20 μm	20=20"	M3=M30(螺纹) M3=M30 type	P=聚四氟乙烯 P=PTFE
3=3 μm	50=50 μm	30=30"	T=222型(平尾) T=222 type	V=氟橡胶 V=FKM
5=5 μm		40=40"	S=226型(翅片) S=226 type	S=硅橡胶 S=silicon



Application

- Polymer and pharmaceuticals, hydraulic oil, water treatment, high temperature gas and other media filter.
- Process water and the process fluid, electroplating, metal etching solution, paint light induced resist, pre filtration of deionized water, bottled water, various kinds of wine, syrup, spice, food oil filter, a variety of acid, alkali, solvent and liquid catalyst chemical agent, condensed water, cooling water, etc.

Technical Parameter

- Type & Size:
Outer Diameter: Φ65mm Length: 10", 20", 30", 40"
Cartridges Connection: M20 type, M30 type, 222 type, 226 type
- Component Material:
Body: 304, 316L
Sealing Ring: EPDM, PTFE, FKM, Silicon
- Performance:
Precision: 0.5 μm, 1 μm, 3 μm, 5 μm, 10 μm, 20 μm, 50 μm

钛棒滤芯 Titanium Filter Cartridge

产品特点

- 无微粒脱落，不污染药液；
- 耐高温(300℃湿态)，耐酸碱腐蚀，抗氧化性强；
- 机械强度高，精度高，可在线再生，易清洗，再生能力强，使用寿命长；
- 化学稳定性好，能耐酸、耐碱，可在较大PH值范围内使用；
- 抗微生物能力强，不与微生物发生作用，可以在生物工程及医学领域应用。

Feature

- No particles fall off, do not pollute the liquid;
- Resistance to high temperature (300 degree), acid and alkali corrosion, strong oxidation resistance;
- Excellent Mechanical strength, high precision, can be online regeneration, easy to clean, strong regeneration ability, long service life;
- Good chemical stability, acid resistance, alkali resistance, can be used in a wide pH range;
- Strong ability to resist microorganisms, not with the role of microorganisms, can be applied in the field of biological engineering and pharmaceuticals.

典型的应用

- 制药行业大输液、小针剂、滴眼液、口服液浓缩环节中的脱碳过滤及精配环节中的终端过滤前的保安过滤；
- 原料药生产过程中的除杂质过滤，物料的脱碳过滤和精滤；
- 水处理工业中的超滤、RO、EDI系统的保安过滤，臭氧灭菌后过滤及臭氧曝气；
- 食品饮料中的饮料、白酒、植物油、醋等澄清过滤；
- 化学工业中液体产品、液体原料、医药中间体的脱碳过滤及精滤。

技术参数

- 滤芯参数：
外径：Φ60mm 长度：10"，20"，30"，40"
滤芯接头：M20、M30222型(平尾)、226型(翅片)
- 部件材质：
滤材：金属钛粉
骨架：304/316L不锈钢骨架
密封圈材质：三元乙丙橡胶，聚四氟乙烯，硅橡胶，氟橡胶
- 滤芯性能：
过滤精度：0.5 μm，1 μm，3 μm，5 μm，10 μm，20 μm，50 μm

JTLXTB 选型表 Selection Table

过滤精度 Precision		滤芯长度 Length	滤芯接头 Cartridges connection	密封材质 Sealing Material
1		10	M2	E
0.5=0.5 μm	10=10 μm	10=10"	M2=M20(螺纹) M2=M20 type	E=三元乙丙橡胶 E= EPDM
1=1 μm	20=20 μm	20=20"	M3=M30(螺纹) M3=M30 type	P=聚四氟乙烯 P=PTFE
3=3 μm	50=50 μm	30=30"	T=222型(平尾) T=222 type	V=氟橡胶 V=FKM
5=5 μm		40=40"	S=226型(翅片) S=226 type	S=硅橡胶 S=silicon



Application

- Decarbonization filtration of Consistency link about transfusion, injection, drop eye drops, oral liquid in Pharmaceutical industry and security filtration of diluted link in the terminal filtration.
- Impurity filtration, decarbonization filtration and fine filtration in API production.
- In water treatment industry, ultrafiltration, RO, EDI system security filtering, ozone filtration and sterilization after ozone aeration.
- Food and beverage beverage, liquor, vegetable oil, vinegar and other clarification filtration.
- Decarbonization and fine filtration of liquid products, raw materials in chemical industry and pharmaceutical intermediates.

Technical Parameter

- Type & Size:
Outer diameter: Φ60mm Length: 10", 20", 30", 40"
Cartridges Connection: M20 type, M30 type, 222 type, 226 type
- Component Material:
Body: Metal titanium powder
Framework: 304/316L stainless steel
Sealing Ring: EPDM, PTFE, FKM, Silicon
- Performance:
Precision: 0.5 μm, 1 μm, 3 μm, 5 μm, 10 μm, 20 μm, 50 μm

大流量滤芯(大胖滤芯) Large Flow Filter Cartridge

产品特点

- 滤芯骨架采用整体注塑工艺, 坚固耐用;
- 渐变孔径结构, 超大过滤面积提供大流量、高寿命和高截流率;
- 过滤水时, 一支滤芯的流量最高可达到850LPM;
- 滤芯更换次数少, 降低滤芯更换成本; 滤芯安装快速、安全、方便、降低劳动成本。

Feature

- Filter frame using the overall injection molding process, strong and durable.
- Tapered aperture structure, large filter area to provide large flow, high life and high closure rate.
- When filtering water, the flow can reach 850 LPM.
- Less changing times to reduce the cost of replacement, installation fast, safe, convenient and reducing labor costs.

典型的应用

- 通用: 反渗透系统预过滤, 工艺用水、工艺气体净化处理;
- 食品饮料工业中各种工艺用水的处理;
- 电子行业中去离子水预过滤;
- 化学/石化工业中酸、碱、溶剂、急冷水等过滤。

技术参数

- 滤芯参数:
外径: $\Phi 152\text{mm}(\Phi 6")$ 长度: 40"
- 部件材质:
滤材: 深层折叠聚丙烯、树脂合成玻纤/聚酯
端盖(滤芯接头)材质: 玻璃纤维增强聚丙烯
密封圈材质: 三元乙丙橡胶, 聚四氟乙烯, 硅橡胶, 氟橡胶
- 滤芯性能:
过滤精度: $1\mu\text{m}$, $3\mu\text{m}$, $5\mu\text{m}$, $10\mu\text{m}$, $20\mu\text{m}$, $50\mu\text{m}$, $70\mu\text{m}$
最高操作温度: 82°C (折叠聚丙烯)、 121°C (折叠玻纤)
最大工作压力差: 3.44Bar @ 82°C (折叠聚丙烯)、
 3.44Bar @ 121°C (折叠玻纤)
滤芯更换推荐压差: 2.48Bar , 20°C
建议最大过滤水流量: 40" 大流量滤芯850LPM

JTLXHF 选型表 Selection Table

过滤精度 Precision		滤芯长度 Length	滤芯接头 Cartridges connection	密封材质 Sealing Material
10		40	A	E
1= $1\mu\text{m}$	20= $20\mu\text{m}$	20=20"	A=Code A	E=三元乙丙橡胶 E= EPDM
3= $3\mu\text{m}$	50= $50\mu\text{m}$	40=40"	B= Code B	P=聚四氟乙烯 P=PTFE
5= $5\mu\text{m}$	70= $70\mu\text{m}$	60=60"		V=氟橡胶 V=FKM
10= $10\mu\text{m}$				S=硅橡胶 S=silicon



Application

- universal: pre filtration in anti infiltration system, purification treatment of process water and process gas.
- various water treatment in food and beverage industry.
- Pre filtration of de ionized water in electronics industry.
- Chemical / petrochemical industry in acid, alkali, solvents, quench water, etc.

Technical Parameter

- Type & Size:
Outer Diameter: $\Phi 152\text{mm}(\Phi 6")$ Length: 40"
- Component Material:
Body: Deep folded polypropylene, resin synthetic glass fiber / polyester
Top (Cartridges Connection): Glass fiber reinforced polypropylene top
(Cartridges Connection)
- Sealing Ring: EPDM, PTFE, FKM, silicon
- Performance:
Precision: $1\mu\text{m}$, $3\mu\text{m}$, $5\mu\text{m}$, $10\mu\text{m}$, $20\mu\text{m}$, $50\mu\text{m}$, $70\mu\text{m}$
Max Operating Temperature: 82°C (Folded polypropylene),
 121°C (Folded glass fiber)
Max Working Pressure Difference: 3.44Bar @ 82°C (Folded polypropylene),
 3.44Bar @ 121°C (Folded glass fiber)
Pressure Difference To Change: 2.48Bar , 20°C
Max Flow: 40" large flow cartridge 850LPM

深层膜堆滤芯(大饼滤芯) Depth-Stack Filter Cartridge (Filter Cake)

产品特点

- 可反冲洗, 过滤量大;
- 操作简单可靠: 牢固的外骨架设计使滤芯在安装和拆卸时不受损坏;
- 热处理后过滤纸板不会变形; 热消毒或热的过滤流体对过滤纸板无不良影响;
- 增加了过滤安全性: 支撑分离板过滤纸板的全面支撑增强了滤芯的稳定性。

Feature

- Can be back washed, large flow;
- The operation is simple and reliable: the firm's outer frame is designed so that the filter element is not damaged during installation and removal;
- After heat treatment, the filter board will not be deformed; the heat disinfection or the hot filtration fluid will have no adverse effect on the filter board;
- Enhance the security of the filter: the support of the separation plate filter board to enhance the overall support of the stability of the filter.

典型的应用

- 澄清过滤: 葡萄酒、啤酒、白酒、果汁、卤水、食用油、高果糖浆、瓶装水;
- 工艺流体, 颗粒去除: 墨水、颜料、树脂、油漆、香水、燃料、硅油;
- 生物制药, 除菌过滤: 血液制品、动物血清、原料药、疫苗、大输液、小输液、细胞分离;
- 化学制剂: 色谱柱保护帽、表面活性剂、催化剂截留。

技术参数

- 大饼滤芯(滤饼)参数:
12"滤饼: 直径 $\Phi 304\text{mm}(\Phi 12")$ 长度: 290mm;
16"滤饼: 直径 $\Phi 423\text{mm}(\Phi 16")$ 长度: 270mm;
- 部件材质:
滤材: 深层滤板: 纤维素, 天然硅藻土, 珍珠岩, 树脂等
内骨架/支撑分离板: 聚丙烯(PP)
密封圈材质: 三元乙丙橡胶, 聚四氟乙烯, 硅橡胶, 氟橡胶
- 滤芯性能:
过滤精度范围: $0.1\mu\text{m} \sim 90\mu\text{m}$
典型过滤精度范围: 应用领域
C002($0.2\mu\text{m} \sim 0.4\mu\text{m}$); C004($0.4\mu\text{m} \sim 0.6\mu\text{m}$): 除菌过滤,
可用于注射 血清、疫苗、生物制品等
C100($1.0\mu\text{m} \sim 1.5\mu\text{m}$); C150($1.5\mu\text{m} \sim 3.0\mu\text{m}$): 精细过滤,
可用于医 保健品、胶体等
C300($3.0\mu\text{m} \sim 6.0\mu\text{m}$); C400($4.0\mu\text{m} \sim 9.0\mu\text{m}$);
C500($5.0\mu\text{m} \sim 10.0\mu\text{m}$): 澄清过滤, 可用于酒 饮料以及工艺流体等

JTLXDB 选型表 Selection Table

滤饼型号 Model of Filter Cake	12	12=12", 16=16"
密封材质 Sealing Material	E	E= EPDM, P=PTFE, V=FKM, S=silicon
过滤精度范围 Precision Range	C100	C002= $0.2\mu\text{m} \sim 0.4\mu\text{m}$, C004= $0.4\mu\text{m} \sim 0.6\mu\text{m}$, C100= $1.0\mu\text{m} \sim 1.5\mu\text{m}$, C150= $1.5\mu\text{m} \sim 3.0\mu\text{m}$, C300= $3.0\mu\text{m} \sim 6.0\mu\text{m}$



Application

- Clarification and filtration: grape, beer, liquor, fruit juice, brine, edible oil, high fructose syrup, bottled water;
- Process fluid, particle removal: ink, paint, resin, varnish, perfume, fuel, silicone oil;
- Bio - pharmaceutical, degerming and filtering: blood products, animal serum, raw material medicine, vaccine, infusion, transfusion, cell separation;
- Chemical agents: column protective enzyme, surfactant, catalyst interception

Technical Parameter

- Type & Size:
12": diameter $\Phi 304\text{mm}(\Phi 12")$ length: 290mm.
16": diameter $\Phi 423\text{mm}(\Phi 16")$ length: 270mm.
- Component Material:
body: Deep filter plate: cellulose, diatomite, perlite, resin etc.
Inner skeleton / support separating plate: polypropylene (PP)
Sealing ring: EPDM, PTFE, FKM, silicon
- Performance:
Precision Range: $0.1\mu\text{m} \sim 90\mu\text{m}$
Referenced Precision Range: Typical applications
C002($0.2\mu\text{m} \sim 0.4\mu\text{m}$), C004($0.4\mu\text{m} \sim 0.6\mu\text{m}$): For injection, serum, vaccines and biological products etc.
C100($1.0\mu\text{m} \sim 1.5\mu\text{m}$), C150($1.5\mu\text{m} \sim 3.0\mu\text{m}$):
For health care products, colloid
C300($3.0\mu\text{m} \sim 6.0\mu\text{m}$), C400($4.0\mu\text{m} \sim 9.0\mu\text{m}$),
C500($5.0\mu\text{m} \sim 10.0\mu\text{m}$): For clarification of wine and beverages,
as well as the process fluid, etc.

